

Magnets shallow pot SmCo, Form A

Item description/product images

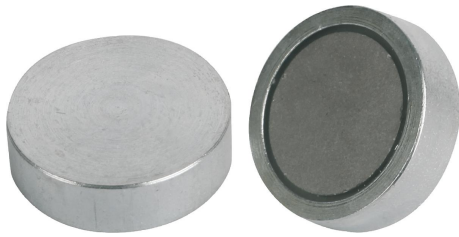

Description

Material:

Housing, steel.
Magnetic core, SmCo.

Version:

Housing, electro zinc-plated.

Note:

Shallow pot magnets, shielded system. Magnets with an SmCo core have three to five times the attracting force of AlNiCo or hard ferrite magnets.

Temperature range:

max. 200°C.

Drawing reference:

1) magnetic face

Drawings

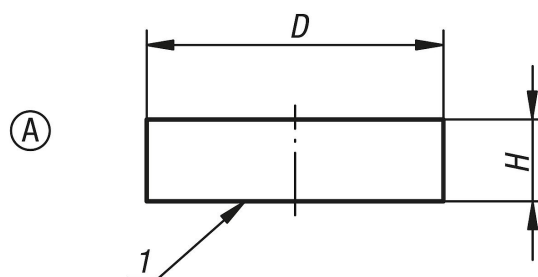

Overview of items

Order No.	Form	D	H	Magnetic force N
K0550.01	A	6 ±0,15	4,5	5
K0550.02	A	8 ±0,15	4,5	11
K0550.03	A	10 ±0,15	4,5	20
K0550.04	A	13 ±0,15	4,5	40
K0550.05	A	16 ±0,15	4,5	60
K0550.06	A	20 ±0,15	6	90
K0550.07	A	25 ±0,15	7	150
K0550.08	A	32 ±0,20	7	220