

## Swivel castors with stop fix

### Item description/product images



### Description

#### Material:

Housing steel plate.  
Wheel treads solid rubber.  
Wheel rims polyamide.

#### Version:

Housing press formed.  
Double ball bearing in the castor head.  
Plain bearing in wheels.

#### Note:

Wheel axle bolted.  
Swivel and fixed castors with bolt hole.  
Wheels grey, non-marking.

### Drawings

swivel castor  
with "stop-fix"

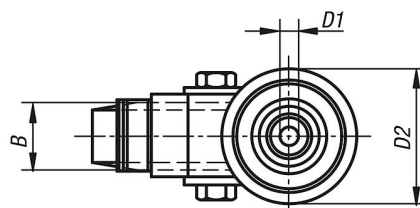
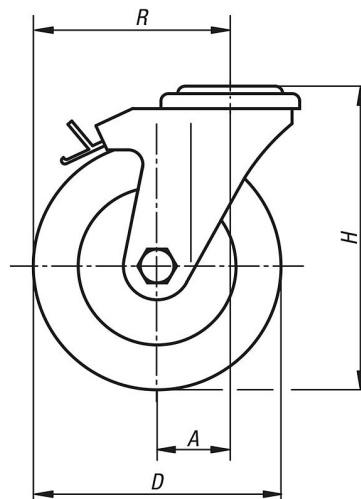

swivel head bearing

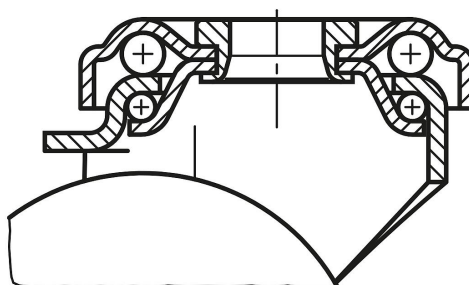

## Swivel castors with stop fix

### Overview of items

Order No.	Item	Version 1	Wheel bearing	A	B	D	D1	D2	H	R	Permissible load kg
K1759.050182	Swivel castor	with stop-fix locking system	plain bearing	25	18	50	11	43	69	50	40
K1759.075252	Swivel castor	with stop-fix locking system	plain bearing	28	25	75	11	43	98	65,5	60
K1759.100252	Swivel castor	with stop-fix locking system	plain bearing	33	25	100	11	43	121	83	70