

Grease nipples flush type DIN 3405

Item description/product images

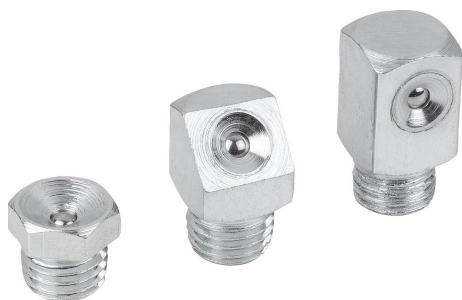

Description

Material:

Steel or 1.4305 stainless steel.

Version:

Steel electro zinc-plated.

Stainless steel bright.

Note:

Flush type grease nipples are particularly suitable for flush or recessed installation. By using flush type nipples, the required lubrication can also be carried out on points with poor accessibility.

Drawing reference:

Form A: straight

Form B: 45°

Form C: 90°

Drawings

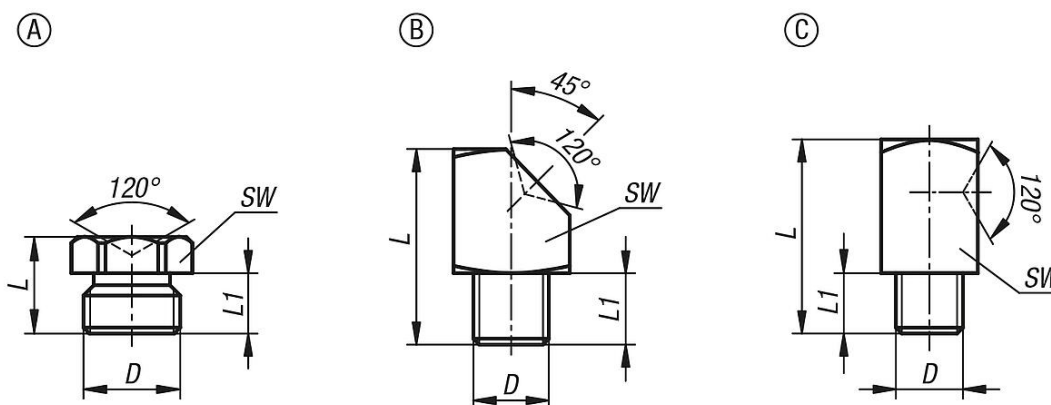

Overview of items

Grease nipples flush type DIN 3405

Order No.	Form	Main material	Version 2	D	L	L1	SW
K1134.1106100	A	steel	hexagon	M6x1	9	6	7
K1134.1108100	A	steel	hexagon	M8x1	9	6	9
K1134.1108125	A	steel	hexagon	M8x1,25	9	6	9
K1134.1110100	A	steel	hexagon	M10x1	9,5	6,5	11
K1134.1118	A	steel	hexagon	R1/8	9	6	11
K1134.2106100	A	stainless steel	hexagon	M6x1	8,2	6	7
K1134.2108100	A	stainless steel	hexagon	M8x1	9,5	6,5	9
K1134.2108125	A	stainless steel	hexagon	M8x1,25	9,5	6,5	9
K1134.2110100	A	stainless steel	hexagon	M10x1	9	6	11
K1134.2118	A	stainless steel	hexagon	G1/8	9	6	11
K1134.1206100	B	steel	square	M6x1	15	5,5	9
K1134.1208100	B	steel	square	M8x1	15	5,5	9
K1134.1208125	B	steel	square	M8x1,25	15	5,5	9
K1134.1210100	B	steel	square	M10x1	15	5,5	11
K1134.1218	B	steel	square	R1/8	15	5,5	11
K1134.1306100	C	steel	square	M6x1	18	5,5	9

Grease nipples flush type DIN 3405

Overview of items

Order No.	Form	Main material	Version 2	D	L	L1	SW
K1134.1308100	C	steel	square	M8x1	18	5,5	9
K1134.1308125	C	steel	square	M8x1,25	18	5,5	9
K1134.1310100	C	steel	square	M10x1	18	5,5	11
K1134.1318	C	steel	square	R1/8	18	5,5	11