

## Eccentric clamp module Form D

### Item description/product images



### Description

**Material:**

Body steel.

Cam levers cast aluminium.

**Version:**

Body black oxidised.

T-nut electro zinc-plated.

Cam levers black powder coated.

**Note:**

The clamp module is inserted into the T-slot from above and secured using the cam lever, no other tools required.

**Advantages:**

The eccentric clamp modules can be used on conventional aluminium profile systems or on T-slot tables as stops, fasteners or clamps for components and workpieces.

# Eccentric clamp module Form D

## Drawings

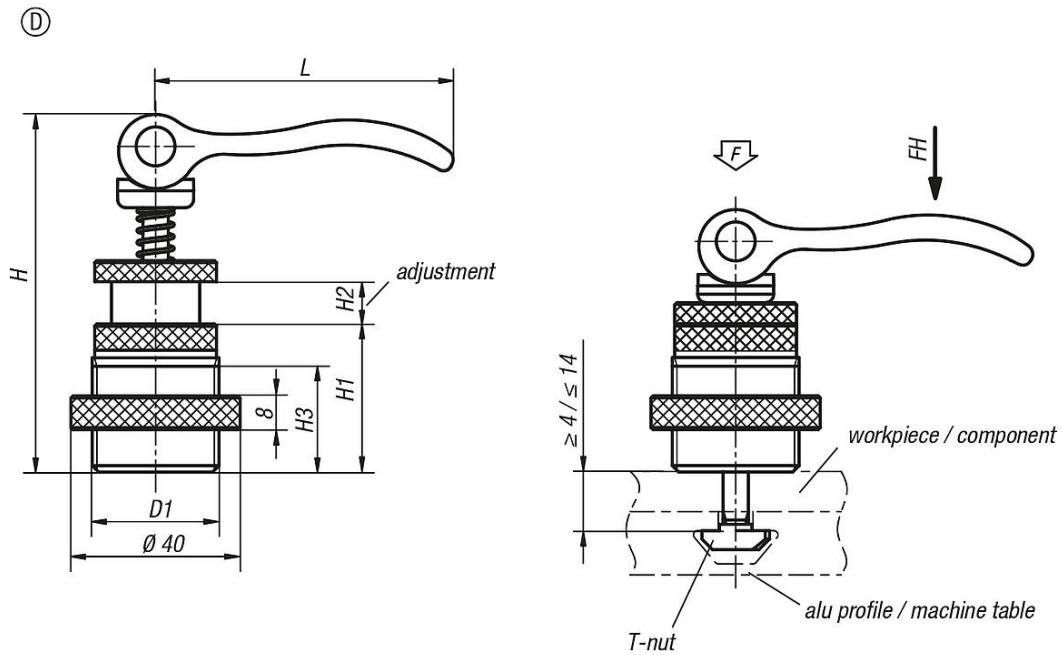

## Overview of items

Order No.	Form	D	D1	D2	H	H1	H2	H3	L	suitable for slot width	Clamping force F (kN)	Hand force FH N
K0754.31301008	D	-	M30x2	40	84,6	35	10	25	70,4	8	4	120