

Stop set

Item description/product images



Description

Material:

Steel.

Version:

Swivel arm, black oxidised.

Stop pin bright.

Note:

Stop set for direct fastening to fixed jaws. The stop can be swivelled aside for machining of the workpiece without losing the stop dimension. Supplied complete with attaching parts.

Drawings

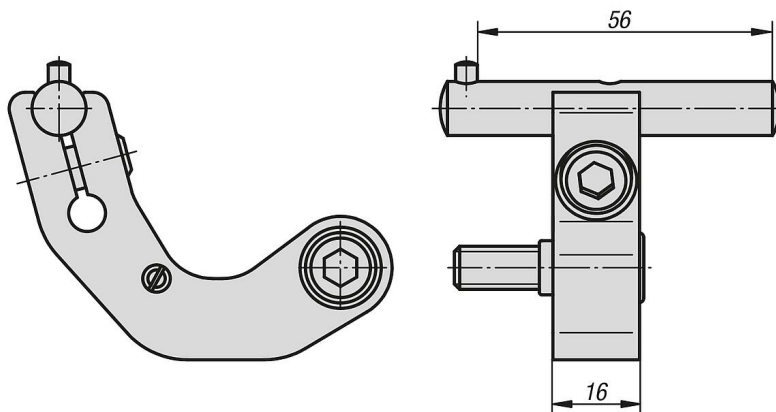

Overview of items

Stop set

Order No.	Suitable for
K0948.100	All 3-axis and 5-axis clamping systems