

"Actima" accessories

Item description/product images



Description

Material, version:

Steel, black oxidised.

Note:

The travel path is 10 mm. Self-locking occurs in any position within only 2 mm of clamp travel, so workpieces with tolerances of up to 1.5 mm can be safely clamped. The Actima clamping device can be mounted in any horizontal or vertical position. Standard parts enable further applications and are available as optional accessories. All parts of the cam system subject to heavy loads are case-hardened (thrust sleeve and accessories only if specified).

The maximum permissible clamping force is approximately 4905 N.

"Actima" accessories

Item description/product images



Drawings

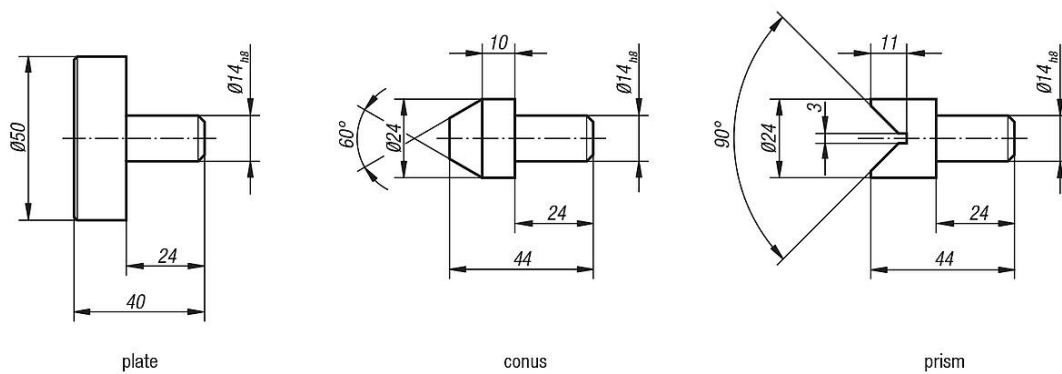

Overview of items

Order No.	Item
K0020.02	Plate
K0020.03	conus
K0020.04	Prism