

Angle, steel open

Item description/product images

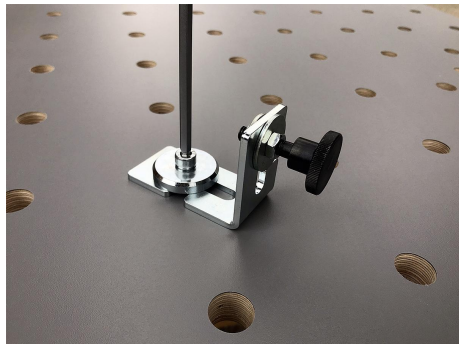

Description

Material:

Steel.

Version:

Electro zinc-plated and trivalent blue passivated.

Note:

The angle can also be used as an end stop on grid hole and slot tables. Fine adjustment is possible when used in combination with knurled screws. The angles are fastened to grid hole tables using clamping pins and washers. They can also be clamped to machine slot tables by combining with eccentric clamp modules.

Advantages:

Flexible movement and positioning.
The opening enables easy assembly.
Infinitely adjustable

Drawings

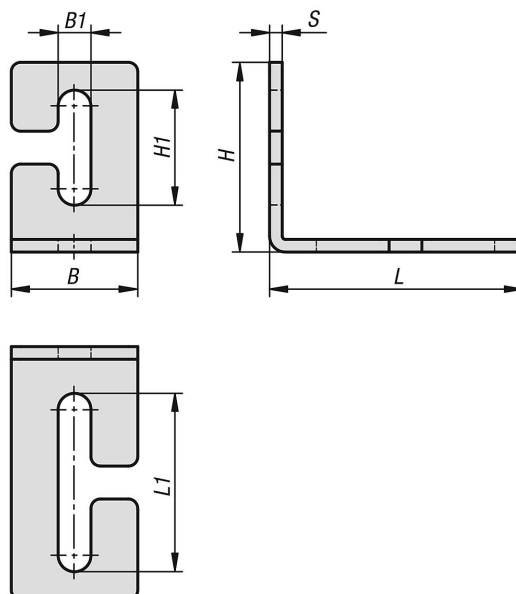

Overview of items

Angle, steel, open

Overview of items

Order No.	B	B1	H	H1	L	L1	S
K1509.0804060	40	10,4	60	36	80	56	4