

# Magnets shallow pot with counterbore SmCo with stainless-steel housing

Item description/product images



## Description

### Material:

Housing stainless steel 1.4104.  
Magnetic core SmCo (samarium cobalt).

### Note:

Shielded system.

### Temperature range:

max. 350°C.

### Assembly:

The magnets can be mounted by press-fit, screwing-in or gluing.

### Drawing reference:

1) magnetic face

## Drawings

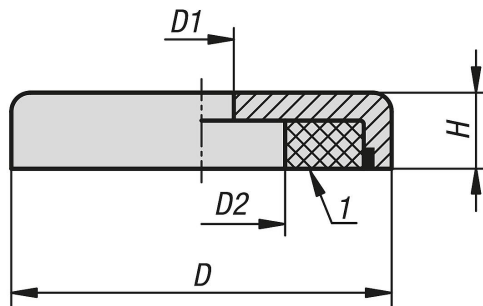

## Overview of items

### Magnets shallow pot with counterbore, SmCo with stainless-steel housing

Order No.	D	D1	D2	H	Magnetic force N
K1399.120	20 ±0,15	4,5	8	6	60
K1399.125	25 ±0,15	4,5	8	7	80
K1399.132	32 ±0,2	5,5	11	7	200
K1399.140	40 ±0,2	5,5	10,5	8	420