

## Handles, Form C

### Item description/product images



### Description

#### Material:

Knobs thermoset PF 31.

Rod steel 1.0718 or stainless steel 1.4305.

#### Version:

Thermoset black, high-gloss polished.

Steel black oxidised or bright stainless steel.

### Drawings

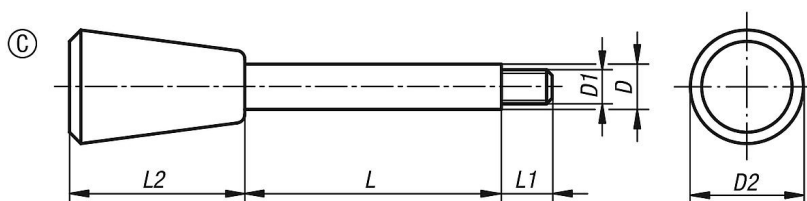

### Overview of items

Order No.	Main material	Form	D	D1	D2	L	L1	L2
K0179.408X35	steel	C	8	M6	20	35	9	31
K0179.408X50	steel	C	8	M6	20	50	9	31
K0179.408X65	steel	C	8	M6	20	65	9	31
K0179.410X50	steel	C	10	M8	25	50	13	38
K0179.410X65	steel	C	10	M8	25	65	13	38
K0179.410X80	steel	C	10	M8	25	80	13	38
K0179.410X100	steel	C	10	M8	25	100	13	38
K0179.412X65	steel	C	12	M10	30	65	15	46
K0179.412X80	steel	C	12	M10	30	80	15	46
K0179.412X100	steel	C	12	M10	30	100	15	46
K0179.412X125	steel	C	12	M10	30	125	15	46
K0179.414X80	steel	C	14	M12	35	80	16	53
K0179.414X100	steel	C	14	M12	35	100	16	53
K0179.414X125	steel	C	14	M12	35	125	16	53
K0179.414X160	steel	C	14	M12	35	160	16	53
K0179.1408X35	stainless steel	C	8	M6	20	35	9	31
K0179.1408X50	stainless steel	C	8	M6	20	50	9	31
K0179.1408X65	stainless steel	C	8	M6	20	65	9	31
K0179.1410X50	stainless steel	C	10	M8	25	50	13	38
K0179.1410X65	stainless steel	C	10	M8	25	65	13	38
K0179.1410X80	stainless steel	C	10	M8	25	80	13	38
K0179.1410X100	stainless steel	C	10	M8	25	100	13	38
K0179.1412X65	stainless steel	C	12	M10	30	65	15	46
K0179.1412X80	stainless steel	C	12	M10	30	80	15	46
K0179.1412X100	stainless steel	C	12	M10	30	100	15	46
K0179.1412X125	stainless steel	C	12	M10	30	125	15	46
K0179.1414X80	stainless steel	C	14	M12	35	80	16	53
K0179.1414X100	stainless steel	C	14	M12	35	100	16	53
K0179.1414X125	stainless steel	C	14	M12	35	125	16	53
K0179.1414X160	stainless steel	C	14	M12	35	160	16	53

