

Self-aligning pads, external thread, with O-ring, Form P, stainless steel ball with polyurethane face

Item description/product images



Description

Material:

Body carbon steel.

Ball stainless steel with polyurethane surface.

Version:

Body tempered and black oxidised.

Ball polyurethane hardness Shore 60.

Note:

The self-aligning pads are used to support and clamp unmachined and machined workpieces.

They also serve as stops, supports and thrust pads in fixture and toolmaking.

Ball secured against rotation.

Form P: The polyurethane surface is vulcanised firmly to the ball. It is abrasion-resistant and does not discolour.

It offers optimum protection against damage to delicate surfaces. The pearl-like surface gives a firm grip and allows air to escape so as to prevent any suction effect between the contact surface and the self-aligning pads.

Advantages:

The built-in O-ring holds the ball in place and keeps dirt and foreign particles out, ensuring uniform movement.

Drawings

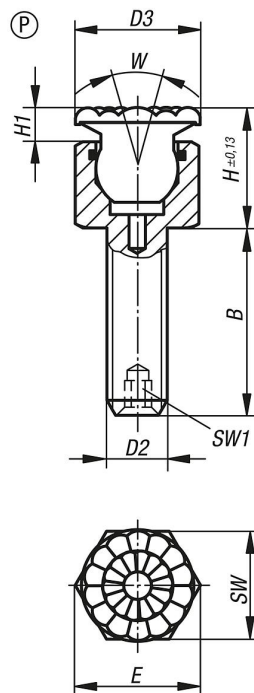

Self-aligning pads, external thread, with O-ring, Form P, stainless steel ball with polyurethane face

Overview of items

Order No.	Form	B	D2	D3	H	H1	E	SW	SW1	W	Ball-Ø
K0288.606X012	P	12	M6	10	12	4	11,5	10	-	28	7
K0288.606X025	P	25	M6	10	12	4	11,5	10	-	28	7
K0288.606X040	P	40	M6	10	12	4	11,5	10	-	28	7
K0288.608X012	P	12	M8	13	16,5	5	15	13	-	28	10
K0288.608X025	P	25	M8	13	16,5	5	15	13	-	28	10
K0288.608X040	P	40	M8	13	16,5	5	15	13	-	28	10
K0288.610X015	P	15	M10	16	18	5	19,6	17	3	28	13
K0288.610X030	P	30	M10	16	18	5	19,6	17	3	28	13
K0288.610X050	P	50	M10	16	18	5	19,6	17	3	28	13
K0288.612X020	P	20	M12	21	21	6	21,9	19	5	24	15
K0288.612X040	P	40	M12	21	21	6	21,9	19	5	24	15
K0288.612X060	P	60	M12	21	21	6	21,9	19	5	24	15
K0288.616X025	P	25	M16	23	25	6	27,7	24	6	24	20
K0288.616X050	P	50	M16	23	25	6	27,7	24	6	24	20
K0288.616X080	P	80	M16	23	25	6	27,7	24	6	24	20