

Crank handles with cylindrical revolving grip, with square socket

Item description/product images



Description

Material:

Crank thermoplastic.
Cylinder grip thermoplastic and steel.

Version:

Black grey thermoplastic.
Steel parts black oxidised.

Note:

The hub cover and the revolving cylinder grip are supplied unassembled.
To assemble, screw the grip into the tapped hole provided.
Versions with transverse bore are secured using the ISO 4027 (DIN 914) grub screw.

Drawing reference:

1) Position of the transverse bore to the keyway is offset by 90°.

Drawings

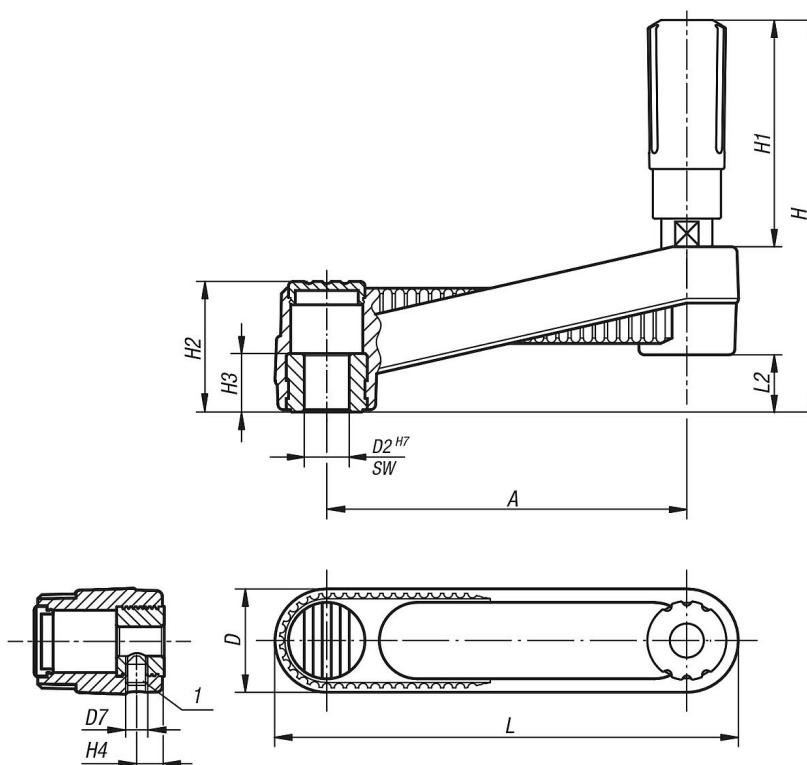

Overview of items

Order No.	Version 1	Version 2	Component material	A	D	D7	H	H1	H2	H3	H4	L	L2	SW
K0659.4108	square socket	without transverse hole	steel	80	24	-	85,8	49,1	28,5	13	-	104	12,7	8
K0659.4110	square socket	without transverse hole	steel	80	24	-	85,8	49,1	28,5	13	-	104	12,7	10
K0659.4210	square socket	without transverse hole	steel	100	29	-	107,1	61,4	35,5	13	-	129	15,7	10
K0659.4212	square socket	without transverse hole	steel	100	29	-	107,1	61,4	35,5	13	-	129	15,7	12
K0659.4312	square socket	without transverse hole	steel	125	36	-	139,5	82,5	44	18,5	-	161	19,5	12
K0659.4314	square socket	without transverse hole	steel	125	36	-	139,5	82,5	44	18,5	-	161	19,5	14

Crank handles with cylindrical revolving grip, with square socket

Overview of items

Order No.	Version 1	Version 2	Component material	A	D	D7	H	H1	H2	H3	H4	L	L2	SW
K0659.41086	square socket	with transverse bore	steel	80	24	-	85,8	49,1	28,5	13	7,5	104	12,7	8
K0659.41106	square socket	with transverse bore	steel	80	24	-	85,8	49,1	28,5	13	7,5	104	12,7	10
K0659.42106	square socket	with transverse bore	steel	100	29	-	107,1	61,4	35,5	13	7,5	129	15,7	10
K0659.42126	square socket	with transverse bore	steel	100	29	-	107,1	61,4	35,5	13	7,5	129	15,7	12
K0659.43126	square socket	with transverse bore	steel	125	36	-	139,5	82,5	44	18,5	7,5	161	19,5	12
K0659.43146	square socket	with transverse bore	steel	125	36	-	139,5	82,5	44	18,5	7,5	161	19,5	14