

Turnbuckles, steel, for chain clamp sets

Item description/product images

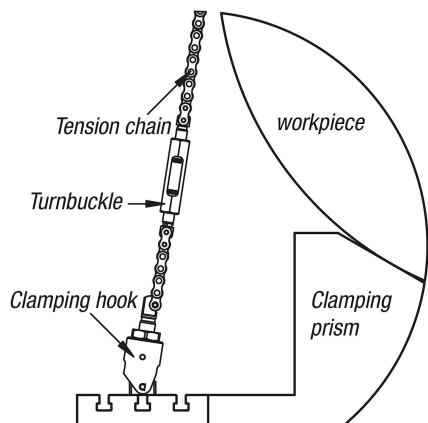

Description

Material:
Steel.

Note:
Steel turnbuckles for chain clamp sets are mounted between the chains. The turnbuckles are used to pre-tension the chain and remove any play, which is always greater with longer chains.

Accessory:
Steel roller chains for chain clamp sets K1655.

Drawings

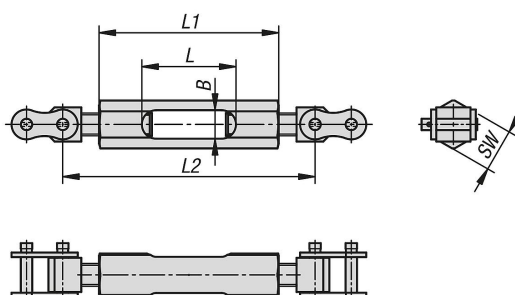

Overview of items

Turnbuckles, steel, for chain clamp sets

Order No.	B	L	L1	L2	SW	Clamping force max. kN
K1656.15052	14	52	97	111-147	24	15
K1656.40066	20	66	126	151-203	30	40