

Recessed handles, stainless steel, fold-down

Item description/product images



Description

Material:

Stainless steel 1.4301.

Version:

High-gloss electropolished.

Note:

Stainless steel retractable grips with marginal installation depth. For base and mounting plates or drawers. With return spring. The grip automatically swivels back into its resting position after use.

Drawing reference:

1) for countersunk screws M4

Recessed handles, stainless steel, fold-down

Drawings

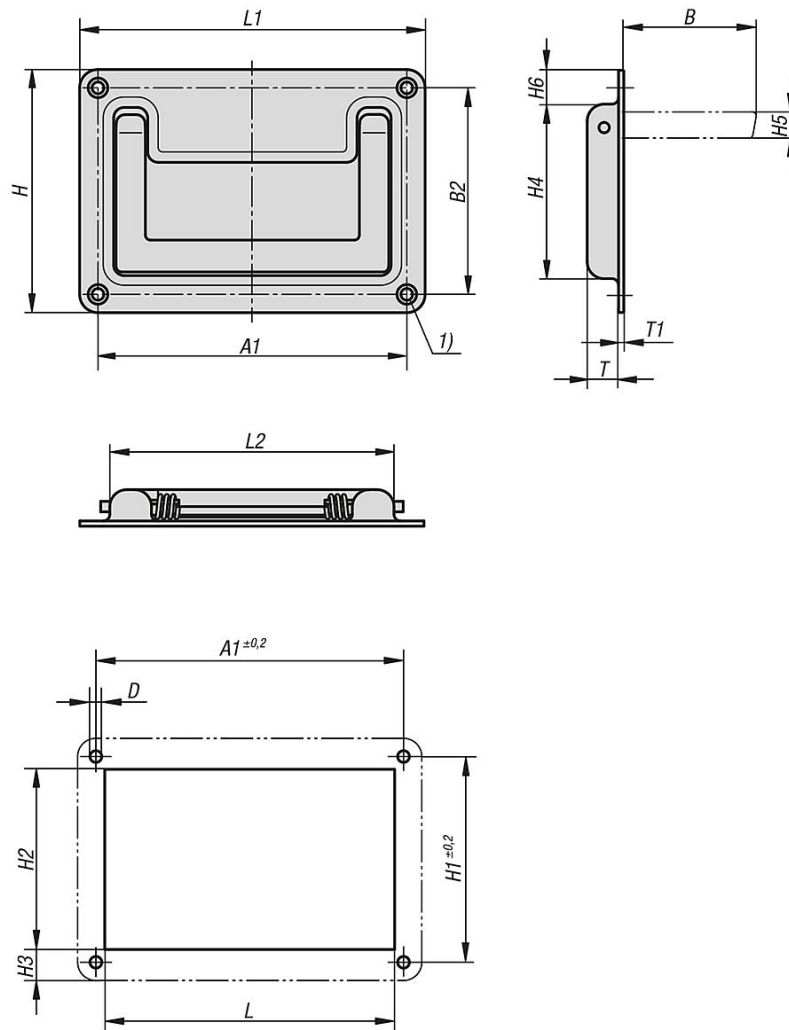

Overview of items

Recessed handles fold-down stainless steel

Order No.	A1	B	B2	D	H	H1	H2	H3	H4	H5	H6	L	L1	L2	T	T1
K1305.132	118±0,2	51	79	4,5	93	79±0,2	72	10,5	67	10	13	115	132	109	12	1,5