

## Self-aligning pads, adjustable with O-ring and hexagon socket, Form 0, stainless steel ball with diamond impregnated face

Item description/product images



### Description

#### Material:

Body carbon steel.

Ball stainless steel diamond impregnated.

#### Version:

Body tempered and black oxidised.

Ball surface comparable to 100 grade abrasive grit.

#### Note:

The self-aligning pads are used to support and clamp unmachined and machined workpieces.

They also serve as stops, supports and thrust pads in fixtures and toolmaking.

Ball secured against rotation.

Form 0: The abrasive diamond surface is bonded firmly to the ball. It is ideally suited to supporting smooth or slippery applications with a minimum of clamping pressure. This allows the diamond particles to get a firm grip on a very small area with minimum damage to the surface.

The diamond surface offers excellent wear resistance.

#### Advantages:

The built-in O-ring holds the ball in place and keeps dirt and foreign particles out, ensuring uniform movement.

The hexagon socket allows easy adjustment and positioning in through holes.

### Drawings

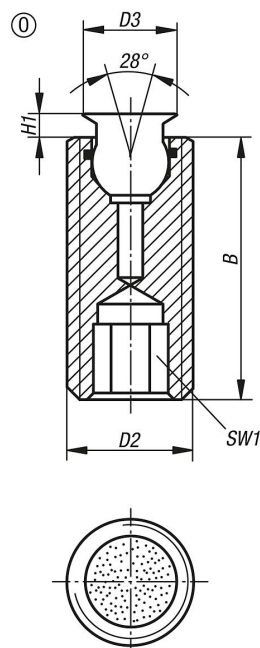

## Self-aligning pads, adjustable with O-ring and hexagon socket, Form 0, stainless steel ball with diamond impregnated face

### Overview of items

Order No.	Form	B	D2	D3	H1	SW1	DK	Load rating max. kN (static load only)
K0290.510X026	0	25	M10	6	1,5	5	5	-
K0290.510X036	0	35	M10	6	1,5	5	5	-
K0290.510X051	0	50	M10	6	1,5	5	5	-
K0290.512X027	0	25	M12	8	2	6	7	15,4
K0290.512X037	0	35	M12	8	2	6	7	15,4
K0290.512X052	0	50	M12	8	2	6	7	15,4
K0290.516X028	0	25	M16	11	3	8	10	23,3
K0290.516X038	0	35	M16	11	3	8	10	23,3
K0290.516X053	0	50	M16	11	3	8	10	23,3
K0290.520X033	0	30	M20	14	3	10	13	37,7
K0290.520X053	0	50	M20	14	3	10	13	37,7
K0290.520X073	0	70	M20	14	3	10	13	37,7