

Tombstones, grey cast iron, double-sided, with pre-machined clamping faces

Item description/product images



Description

Material:

GJL 300.

Version:

Support and clamping faces are precision-machined.

The clamping faces have a +1 mm allowance.

Note:

Tombstones with pre-machined clamping faces provide a fast and economic method of producing a body with specific grid or individual holes. The base is ready for mounting on the machine table. The two clamping faces can be machined to the end dimensions by the user. The tombstones conform to machine tables for machine tools acc. to DIN 55201 and JIS6337-1980.

Please order locating pins for positioning subplates on machine tables acc. to DIN 55201 separately.

Ring bolts for hoisting are supplied.

Other dimensions available on request.

Drawing reference:

1) hole for DIN 912 cap screw (D3/D4)

Tombstones, grey cast iron, double-sided, with pre-machined clamping faces

Drawings

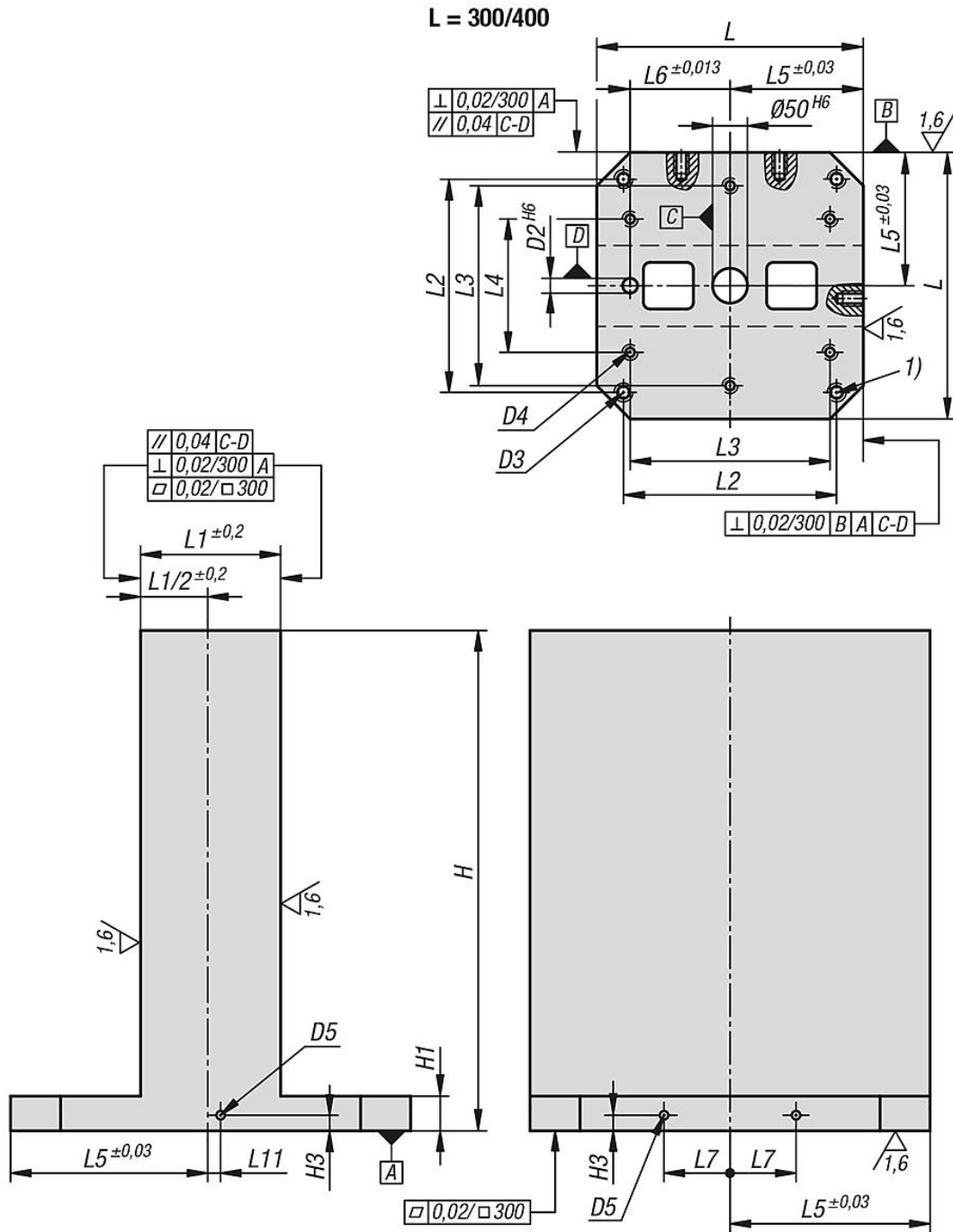

Tombstones, grey cast iron, double-sided, with pre-machined clamping faces

Drawings

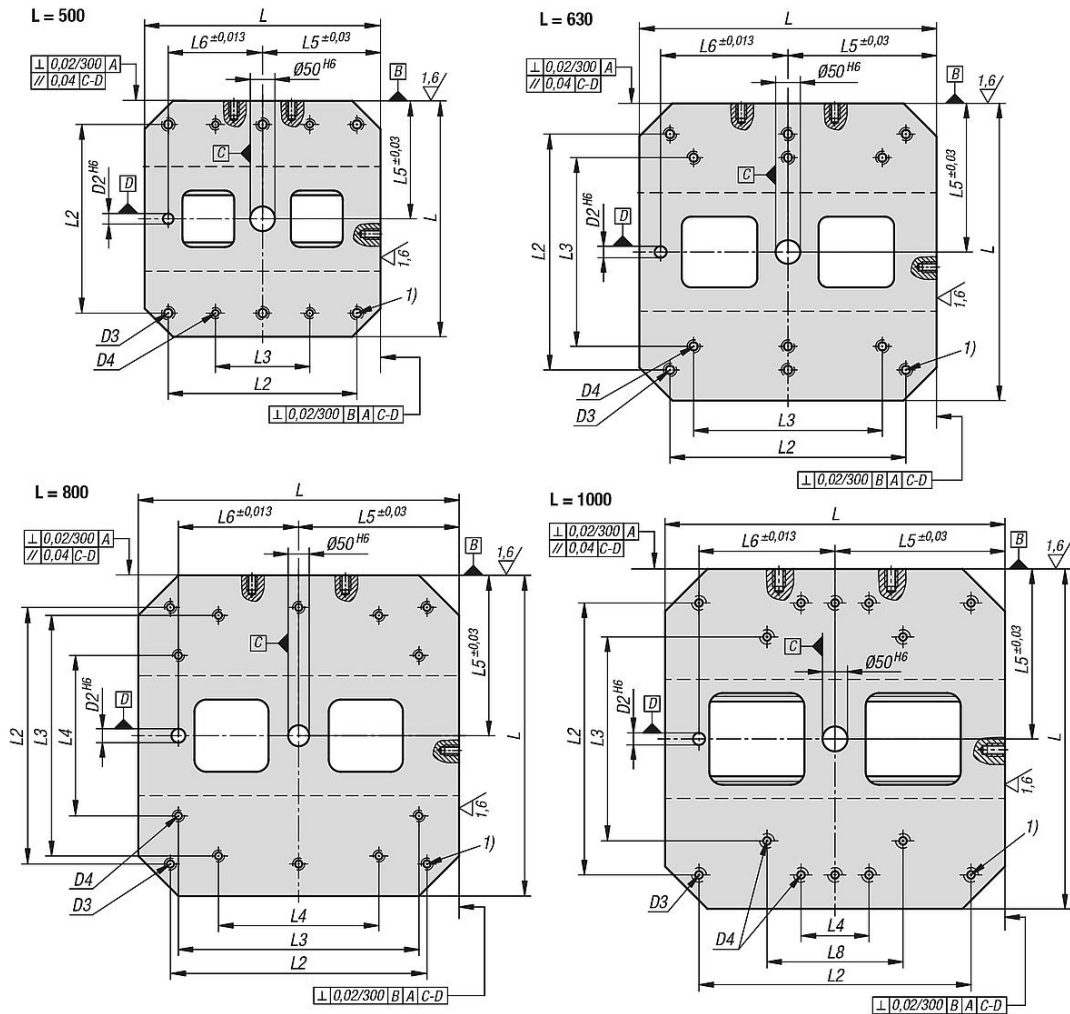

Overview of items

Tombstones, grey cast iron, double-sided, with pre-machined clamping faces

| Order No. | L | H | H1 | D2 | D3 | D4 | D5 | H3 | L1 | L2 | L3 | L4 | L5 | L6 | L7 | L8 | L11 |
|-----------------|------|------|----|----|-----|-----|-----|----|-----|-----|-----|-----|-----|-----|-----|-----|-----|
| K0803.100030050 | 300 | 500 | 50 | 20 | M12 | M10 | M12 | 15 | 81 | 250 | 200 | - | 150 | 100 | 40 | - | 0 |
| K0803.100040050 | 400 | 500 | 50 | 20 | M16 | M12 | M16 | 18 | 151 | 320 | 300 | 200 | 200 | 150 | 55 | - | 25 |
| K0803.100040065 | 400 | 650 | 50 | 20 | M16 | M12 | M16 | 18 | 151 | 320 | 300 | 200 | 200 | 150 | 55 | - | 25 |
| K0803.100050060 | 500 | 600 | 50 | 20 | M16 | M12 | M16 | 18 | 201 | 400 | 200 | - | 250 | 200 | 75 | - | 25 |
| K0803.100050075 | 500 | 750 | 50 | 20 | M16 | M12 | M16 | 18 | 201 | 400 | 200 | - | 250 | 200 | 75 | - | 25 |
| K0803.100063070 | 630 | 700 | 50 | 25 | M16 | M16 | M16 | 18 | 251 | 500 | 400 | - | 315 | 200 | 100 | - | 25 |
| K0803.100063085 | 630 | 850 | 50 | 25 | M16 | M16 | M16 | 18 | 251 | 500 | 400 | - | 315 | 200 | 100 | - | 25 |
| K0803.100080080 | 800 | 800 | 50 | 25 | M16 | M16 | M16 | 18 | 301 | 640 | 600 | 400 | 400 | 300 | 135 | - | 25 |
| K0803.100080100 | 800 | 1000 | 50 | 25 | M16 | M16 | M16 | 18 | 301 | 640 | 600 | 400 | 400 | 300 | 135 | - | 25 |
| K0803.100100100 | 1000 | 1000 | 55 | 25 | M20 | M20 | M16 | 18 | 351 | 800 | 600 | 200 | 500 | 400 | 165 | 400 | 25 |
| K0803.100100125 | 1000 | 1250 | 55 | 25 | M20 | M20 | M16 | 18 | 351 | 800 | 600 | 200 | 500 | 400 | 165 | 400 | 25 |

Tombstones, grey cast iron, double-sided, with pre-machined clamping faces

