

## Quarter-turn locks, stainless steel with L-grip

### Item description/product images



### Description

**Material:**

Stainless steel 1.4401.

**Version:**

Bright.

Grip polished.

**Note:**

Quarter-turn lock with L-grip. For right or left mounting with 90° closing. The quarter-turn lock can be installed pre-assembled. Rating IP65.

Please order required tongue version separately. Every tongue can be combined with this housing.

The lockable quarter-turn locks are each supplied with 2 keys. The cylinder locks have a single key system i.e. the same key works in all locks (cylinder lock 1333).

\*Dimension A results from the combination of the quarter turn lock and the tongue and is specified with the matching tongues.

**On request:**

Available for door thickness 20 and 40 mm.

**Accessory:**

Key for quarter-turn lock K1511.

Tongue for stainless steel quarter-turn lock K1340.

### Drawings

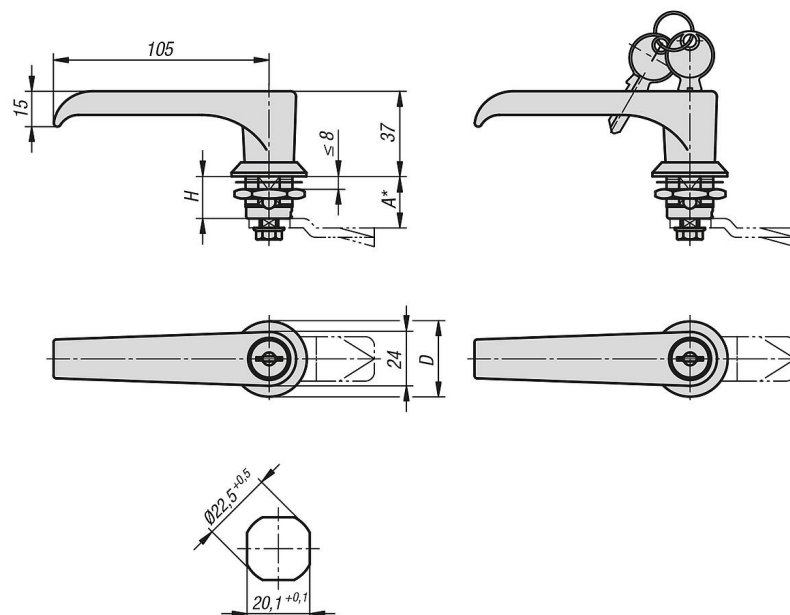

### Overview of items

## Quarter-turn locks, stainless steel with L-grip

### Overview of items

#### Quarter-turn locks, stainless steel with L-grip

Order No.	Actuation	D	H
K1359.118	L-grip	32	18
K1359.218	lockable L-grip	32	18