

# Spring hinges steel or stainless steel, 120 mm, spring closed

## Item description/product images



### Description

#### Material:

Steel or 1.4301 stainless steel.  
Tension spring stainless steel.

#### Version:

Steel bright or galvanised.  
Stainless steel bright.

#### Note:

Butt type hinges.  
Opening angle 270°.

Spring torque:

$M(0^\circ)$ : 0.28 Nm /  $M(90^\circ)$ : 0.56 Nm /  $M(180^\circ)$ : 0.85 Nm

Form A: without holes

Form B: with holes

## Drawings

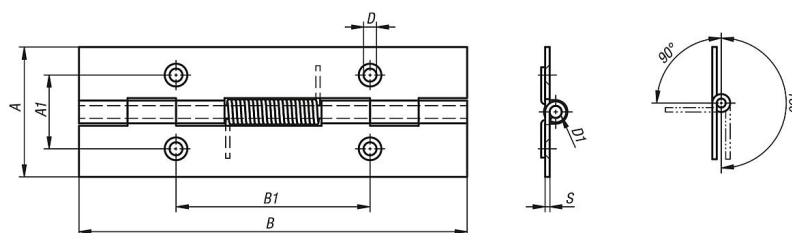

## Overview of items

Order No.	Form	Version	Main material	Base colour	A	A1	B	B1	D	D1	S
K1175.4012010	A	spring closed	steel	bright	40	-	120	-	-	4	1,5
K1175.4012011	B	spring closed	steel	Galvanized	40	22,7	120	60	4	4	1,5
K1175.14012010	A	spring closed	stainless steel	bright	40	-	120	-	-	4	1,5
K1175.14012011	B	spring closed	stainless steel	bright	40	22,7	120	60	4	4	1,5