

Knurled knobs with external thread

Item description/product images



Description

Material:

Grip black grey thermoplastic.
 Bush brass or stainless steel 1.4305.
 Screw steel 5.8 or stainless steel 1.4305.

Version:

Steel trivalent blue passivated.
 Stainless steel, bright.

On request:

Other colours.

Drawings

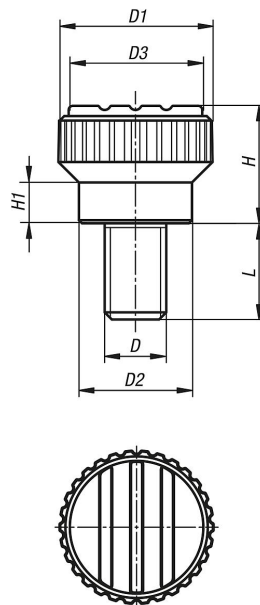

Overview of items

Order No.	Thread type	Component material	D	D1	D2	D3	H	H1	L
K0110.003X8	external thread	steel	M3	15	11	13	11,5	4,3	8
K0110.003X10	external thread	steel	M3	15	11	13	11,5	4,3	10
K0110.003X12	external thread	steel	M3	15	11	13	11,5	4,3	12
K0110.003X15	external thread	steel	M3	15	11	13	11,5	4,3	15
K0110.004X8	external thread	steel	M4	15	11	13	11,5	4,3	8
K0110.004X10	external thread	steel	M4	15	11	13	11,5	4,3	10
K0110.004X12	external thread	steel	M4	15	11	13	11,5	4,3	12
K0110.004X15	external thread	steel	M4	15	11	13	11,5	4,3	15

Knurled knobs with external thread

Overview of items

Order No.	Thread type	Component material	D	D1	D2	D3	H	H1	L
K0110.005X10	external thread	steel	M5	15	11	13	11,5	4,3	10
K0110.005X12	external thread	steel	M5	15	11	13	11,5	4,3	12
K0110.005X15	external thread	steel	M5	15	11	13	11,5	4,3	15
K0110.005X20	external thread	steel	M5	15	11	13	11,5	4,3	20
K0110.006X10	external thread	steel	M6	15	11	13	11,5	4,3	10
K0110.006X15	external thread	steel	M6	15	11	13	11,5	4,3	15
K0110.006X20	external thread	steel	M6	15	11	13	11,5	4,3	20
K0110.006X25	external thread	steel	M6	15	11	13	11,5	4,3	25
K0110.0003X8	external thread	stainless steel	M3	15	11	13	11,5	4,3	8
K0110.0003X10	external thread	stainless steel	M3	15	11	13	11,5	4,3	10
K0110.0003X12	external thread	stainless steel	M3	15	11	13	11,5	4,3	12
K0110.0003X15	external thread	stainless steel	M3	15	11	13	11,5	4,3	15
K0110.0004X8	external thread	stainless steel	M4	15	11	13	11,5	4,3	8
K0110.0004X10	external thread	stainless steel	M4	15	11	13	11,5	4,3	10
K0110.0004X12	external thread	stainless steel	M4	15	11	13	11,5	4,3	12
K0110.0004X15	external thread	stainless steel	M4	15	11	13	11,5	4,3	15
K0110.0005X10	external thread	stainless steel	M5	15	11	13	11,5	4,3	10
K0110.0005X12	external thread	stainless steel	M5	15	11	13	11,5	4,3	12
K0110.0005X15	external thread	stainless steel	M5	15	11	13	11,5	4,3	15
K0110.0005X20	external thread	stainless steel	M5	15	11	13	11,5	4,3	20
K0110.0006X10	external thread	stainless steel	M6	15	11	13	11,5	4,3	10
K0110.0006X15	external thread	stainless steel	M6	15	11	13	11,5	4,3	15
K0110.0006X20	external thread	stainless steel	M6	15	11	13	11,5	4,3	20
K0110.0006X25	external thread	stainless steel	M6	15	11	13	11,5	4,3	25