

Assembly tool, steel for self-tapping threaded inserts, type B

Item description/product images



Description

Material:
Steel.

Version:
Manual assembly tool, electro zinc-plated.

Note:
Inserts are screwed in using this manual assembly tool together with a tap wrench, socket set, cordless screwdriver etc.

Drawings

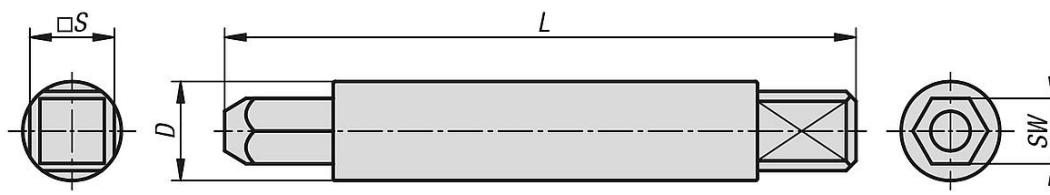

Overview of items

Assembly tool, steel, for self-tapping threaded inserts type B

Order No.	SW	L length	S	D
K1538.808	6,6	64	8	10