

Centring clamp round with socket head screw, Form B

Item description/product images



Description

Material:

Carbon steel.

Version:

Hardened (33–39 HRC) and black oxidised.

Note:

The centring clamp enables a workpiece to be centred and clamped in the bore. The wedges generate higher clamping forces. Centring clamp with pull-down effect.

Drawing reference:

Dimension H refers to the height at $\geq D$.

1) O-ring

Technical information:

- These clamps grip the inside diameter of a workpiece.
- The wedge shape enables high clamping forces on the workpiece.

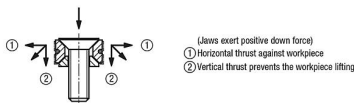

Form A:

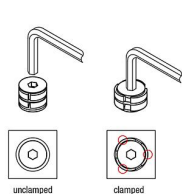

Form B:

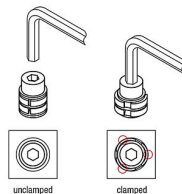

Note:
The clamp makes point contact with the bore wall when clamped.

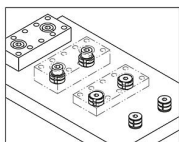

For accurate repeat positioning use these clamps together with a positioning unit.

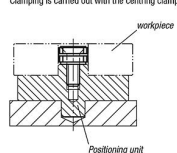

Centring clamp round with socket head screw, Form B

Drawings

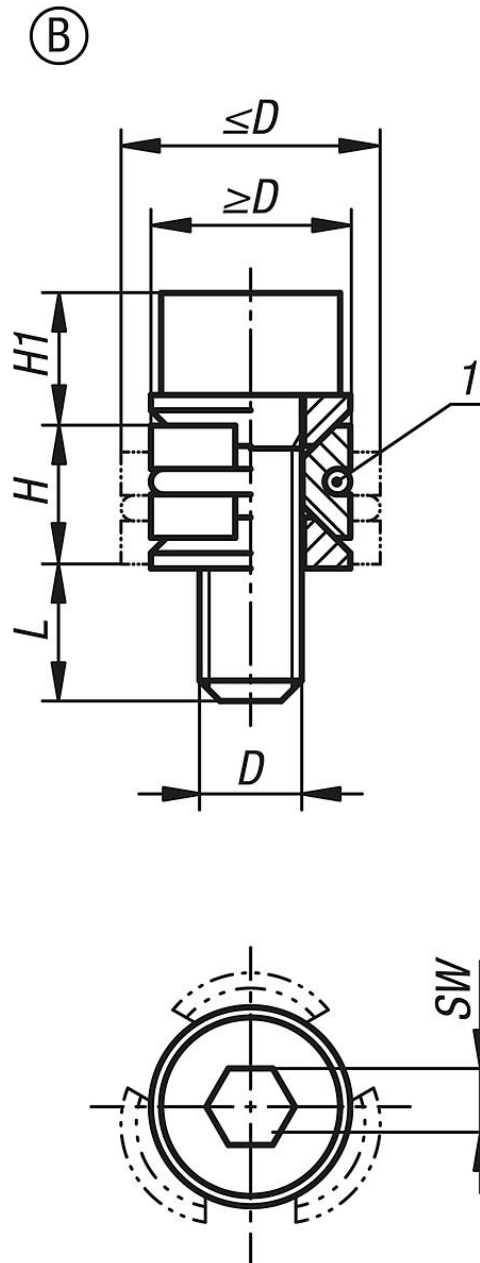

Overview of items

Order No.	Form	D=Thread	D min.	D max.	H	H1	L	SW	Clamping force max. kN	Tightening torque Nm
K1166.20804	B	M4x12	8	10,3	5,5	5,1	7,1	3	1,5	2,7
K1166.21005	B	M5X15	10	12,3	6,4	6,2	9	4	2,5	5,4
K1166.21206	B	M6X18	12	16,3	8,6	7,9	10,6	5	5	9,1
K1166.21608	B	M8X25	16	22	11,5	10,4	15,4	6	9	25

