

Clamping bolts

Item description/product images



Description

Material:

Clamping bolt, steel.
Clamping screw, carbon steel.
Clamping ring brass.

Version:

Clamping bolt hardened and black oxidised.
Clamping screw black oxidised.
Clamping ring bright.

Note:

The clamping bolts can be fixed to the machine table directly with T-slot nuts. Clamping parallel to the table is guaranteed by low tolerance classes (js6) for the height. The clamping range is 8 – 40 mm. Clamping screws for the ranges 40 – 67 and 65 – 87 mm are also available. The intermediate plate prevents damage to the machine table, as well as shifting during tightening. The brass clamping ring prevents impressions on the workpiece.

Drawings

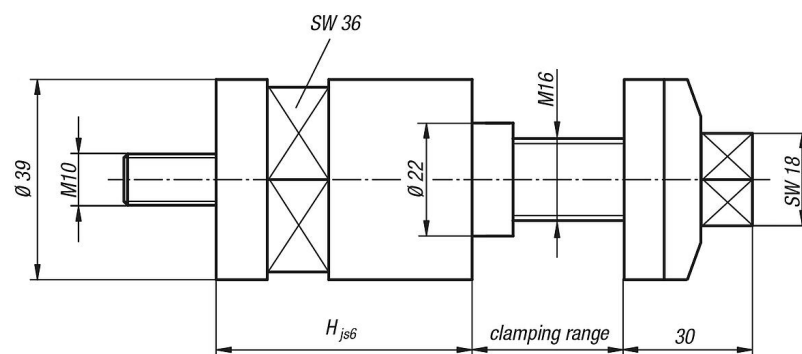

Overview of items

Clamping bolts

Order No.	H	Clamp range
K1232.050	50	8-40

Clamping bolts

Overview of items

Order No.	H	Clamp range
K1232.100	100	8-40

Clamping screws

Order No.	Clamp range
K1232.4067	40-67
K1232.6587	65-87