

Socket head screws with low head DIN 6912

Item description/product images



Description

Material:

Steel, stainless steel A2 or stainless steel A4.

Version:

Steel grade 8.8, bright (black) or electro zinc-plated.
 Steel grade 10.9, bright (black) or electro zinc-plated.
 Stainless steel A2-70, bright.
 Stainless steel A4-70, bright.

Drawings

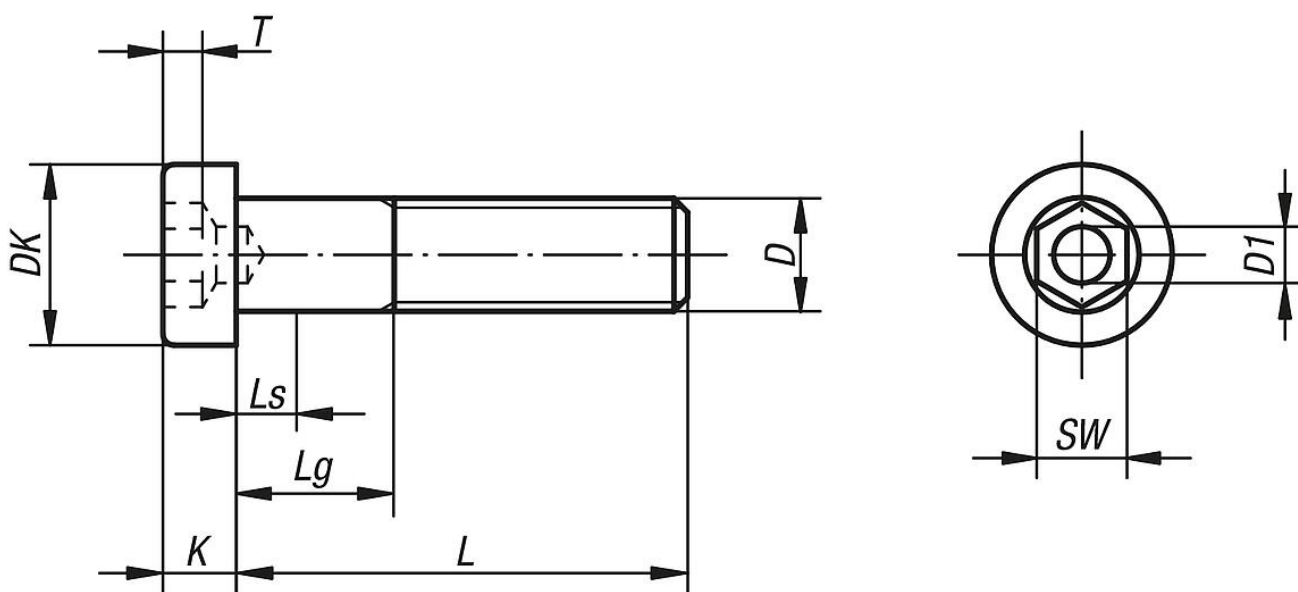

Overview of items

Order No.	Main material	Grade	Surface finish body	D	L	Ls min.	Lg max.	DK	K	D1	SW	T
K1160.04X10	steel	8.8	bright (black)	M4	10	1,4	3,5	7	2,8	2	3	1,48
K1160.04X12	steel	8.8	bright (black)	M4	12	1,4	3,5	7	2,8	2	3	1,48
K1160.04X16	steel	8.8	bright (black)	M4	16	1,4	3,5	7	2,8	2	3	1,48
K1160.04X20	steel	8.8	bright (black)	M4	20	2,5	6	7	2,8	2	3	1,48
K1160.04X25	steel	8.8	bright (black)	M4	25	7,5	11	7	2,8	2	3	1,48
K1160.05X10	steel	8.8	bright (black)	M5	10	1,8	4,2	8,5	3,5	2,5	4	1,88
K1160.05X12	steel	8.8	bright (black)	M5	12	1,8	4,2	8,5	3,5	2,5	4	1,88
K1160.05X16	steel	8.8	bright (black)	M5	16	1,8	4,2	8,5	3,5	2,5	4	1,88
K1160.05X20	steel	8.8	bright (black)	M5	20	1,8	4,2	8,5	3,5	2,5	4	1,88
K1160.05X25	steel	8.8	bright (black)	M5	25	5	9	8,5	3,5	2,5	4	1,88
K1160.05X30	steel	8.8	bright (black)	M5	30	10	14	8,5	3,5	2,5	4	1,88
K1160.06X10	steel	8.8	bright (black)	M6	10	2,5	5,5	10	4	3	5	2,38
K1160.06X12	steel	8.8	bright (black)	M6	12	2,5	5,5	10	4	3	5	2,38
K1160.06X16	steel	8.8	bright (black)	M6	16	2,5	5,5	10	4	3	5	2,38
K1160.06X20	steel	8.8	bright (black)	M6	20	2,5	5,5	10	4	3	5	2,38
K1160.06X25	steel	8.8	bright (black)	M6	25	2,5	5,5	10	4	3	5	2,38
K1160.06X30	steel	8.8	bright (black)	M6	30	7	12	10	4	3	5	2,38
K1160.06X35	steel	8.8	bright (black)	M6	35	12	17	10	4	3	5	2,38
K1160.06X40	steel	8.8	bright (black)	M6	40	17	22	10	4	3	5	2,38
K1160.06X45	steel	8.8	bright (black)	M6	45	22	27	10	4	3	5	2,38

Socket head screws with low head DIN 6912

Overview of items

Order No.	Main material	Grade	Surface finish body	D	L	Ls min.	Lg max.	DK	K	D1	SW	T
K1160.06X50	steel	8.8	bright (black)	M6	50	27	32	10	4	3	5	2,38
K1160.06X60	steel	8.8	bright (black)	M6	60	37	42	10	4	3	5	2,38
K1160.08X10	steel	8.8	bright (black)	M8	10	0	6,25	13	5	4	6	2,88
K1160.08X12	steel	8.8	bright (black)	M8	12	3,2	7	13	5	4	6	2,88
K1160.08X16	steel	8.8	bright (black)	M8	16	3,2	7	13	5	4	6	2,88
K1160.08X20	steel	8.8	bright (black)	M8	20	3,2	7	13	5	4	6	2,88
K1160.08X25	steel	8.8	bright (black)	M8	25	3,2	7	13	5	4	6	2,88
K1160.08X30	steel	8.8	bright (black)	M8	30	3,2	7	13	5	4	6	2,88
K1160.08X35	steel	8.8	bright (black)	M8	35	6,75	13	13	5	4	6	2,88
K1160.08X40	steel	8.8	bright (black)	M8	40	11,75	18	13	5	4	6	2,88
K1160.08X45	steel	8.8	bright (black)	M8	45	16,75	23	13	5	4	6	2,88
K1160.08X50	steel	8.8	bright (black)	M8	50	21,75	28	13	5	4	6	2,88
K1160.08X60	steel	8.8	bright (black)	M8	60	31,75	38	13	5	4	6	2,88
K1160.08X70	steel	8.8	bright (black)	M8	70	41,75	48	13	5	4	6	2,88
K1160.08X80	steel	8.8	bright (black)	M8	80	51,75	58	13	5	4	6	2,88
K1160.10X20	steel	8.8	bright (black)	M10	20	3,5	8	16	6,5	5	8	3,35
K1160.10X25	steel	8.8	bright (black)	M10	25	3,5	8	16	6,5	5	8	3,35
K1160.10X30	steel	8.8	bright (black)	M10	30	3,5	8	16	6,5	5	8	3,35
K1160.10X35	steel	8.8	bright (black)	M10	35	3,5	8	16	6,5	5	8	3,35
K1160.10X40	steel	8.8	bright (black)	M10	40	6,5	14	16	6,5	5	8	3,35
K1160.10X45	steel	8.8	bright (black)	M10	45	11,5	19	16	6,5	5	8	3,35
K1160.10X50	steel	8.8	bright (black)	M10	50	16,5	24	16	6,5	5	8	3,35
K1160.10X60	steel	8.8	bright (black)	M10	60	26,5	34	16	6,5	5	8	3,35
K1160.10X70	steel	8.8	bright (black)	M10	70	36,5	44	16	6,5	5	8	3,35
K1160.10X80	steel	8.8	bright (black)	M10	80	46,5	54	16	6,5	5	8	3,35
K1160.10X90	steel	8.8	bright (black)	M10	90	56,5	64	16	6,5	5	8	3,35
K1160.10X100	steel	8.8	bright (black)	M10	100	66,5	65	16	6,5	5	8	3,35
K1160.12X20	steel	8.8	bright (black)	M12	20	4,2	9,5	18	7,5	6	10	3,85
K1160.12X25	steel	8.8	bright (black)	M12	25	4,2	9,5	18	7,5	6	10	3,85
K1160.12X30	steel	8.8	bright (black)	M12	30	4,2	9,5	18	7,5	6	10	3,85
K1160.12X35	steel	8.8	bright (black)	M12	35	4,2	9,5	18	7,5	6	10	3,85
K1160.12X40	steel	8.8	bright (black)	M12	40	4,2	9,5	18	7,5	6	10	3,85
K1160.12X45	steel	8.8	bright (black)	M12	45	6,5	15	18	7,5	6	10	3,85
K1160.12X50	steel	8.8	bright (black)	M12	50	11,5	20	18	7,5	6	10	3,85
K1160.12X60	steel	8.8	bright (black)	M12	60	21,5	30	18	7,5	6	10	3,85
K1160.12X70	steel	8.8	bright (black)	M12	70	31,5	40	18	7,5	6	10	3,85
K1160.12X80	steel	8.8	bright (black)	M12	80	41,5	50	18	7,5	6	10	3,85
K1160.12X90	steel	8.8	bright (black)	M12	90	51,5	60	18	7,5	6	10	3,85
K1160.12X100	steel	8.8	bright (black)	M12	100	61,5	70	18	7,5	6	10	3,85
K1160.12X110	steel	8.8	bright (black)	M12	110	71,5	80	18	7,5	6	10	3,85
K1160.12X120	steel	8.8	bright (black)	M12	120	81,5	90	18	7,5	6	10	3,85
K1160.16X30	steel	8.8	bright (black)	M16	30	5	11	24	10	8	14	5,35
K1160.16X35	steel	8.8	bright (black)	M16	35	5	11	24	10	8	14	5,35
K1160.16X40	steel	8.8	bright (black)	M16	40	5	11	24	10	8	14	5,35
K1160.16X45	steel	8.8	bright (black)	M16	45	5	11	24	10	8	14	5,35
K1160.16X50	steel	8.8	bright (black)	M16	50	5	11	24	10	8	14	5,35
K1160.16X60	steel	8.8	bright (black)	M16	60	12	22	24	10	8	14	5,35
K1160.16X70	steel	8.8	bright (black)	M16	70	22	32	24	10	8	14	5,35
K1160.16X80	steel	8.8	bright (black)	M16	80	32	42	24	10	8	14	5,35
K1160.16X90	steel	8.8	bright (black)	M16	90	42	52	24	10	8	14	5,35
K1160.16X100	steel	8.8	bright (black)	M16	100	52	62	24	10	8	14	5,35
K1160.16X110	steel	8.8	bright (black)	M16	110	62	72	24	10	8	14	5,35
K1160.16X120	steel	8.8	bright (black)	M16	120	72	82	24	10	8	14	5,35
K1160.20X40	steel	8.8	bright (black)	M20	40	6,5	14	30	12	10	17	6,32
K1160.20X45	steel	8.8	bright (black)	M20	45	6,5	14	30	12	10	17	6,32
K1160.20X50	steel	8.8	bright (black)	M20	50	6,5	14	30	12	10	17	6,32
K1160.20X60	steel	8.8	bright (black)	M20	60	6,5	14	30	12	10	17	6,32
K1160.20X70	steel	8.8	bright (black)	M20	70	11,5	24	30	12	10	17	6,32
K1160.20X80	steel	8.8	bright (black)	M20	80	21,5	34	30	12	10	17	6,32
K1160.20X90	steel	8.8	bright (black)	M20	90	31,5	44	30	12	10	17	6,32
K1160.20X100	steel	8.8	bright (black)	M20	100	41,5	54	30	12	10	17	6,32
K1160.20X110	steel	8.8	bright (black)	M20	110	51,5	64	30	12	10	17	6,32

Socket head screws with low head DIN 6912

Overview of items

Order No.	Main material	Grade	Surface finish body	D	L	Ls min.	Lg max.	DK	K	D1	SW	T
K1160.20X120	steel	8.8	bright (black)	M20	120	61,5	74	30	12	10	17	6,32
K1160.404X10	steel	8.8	galvanised	M4	10	1,4	3,5	7	2,8	2	3	1,48
K1160.404X12	steel	8.8	galvanised	M4	12	1,4	3,5	7	2,8	2	3	1,48
K1160.404X16	steel	8.8	galvanised	M4	16	1,4	3,5	7	2,8	2	3	1,48
K1160.404X20	steel	8.8	galvanised	M4	20	2,5	6	7	2,8	2	3	1,48
K1160.404X25	steel	8.8	galvanised	M4	25	7,5	11	7	2,8	2	3	1,48
K1160.405X10	steel	8.8	galvanised	M5	10	1,8	4,2	8,5	3,5	2,5	4	1,88
K1160.405X12	steel	8.8	galvanised	M5	12	1,8	4,2	8,5	3,5	2,5	4	1,88
K1160.405X16	steel	8.8	galvanised	M5	16	1,8	4,2	8,5	3,5	2,5	4	1,88
K1160.405X20	steel	8.8	galvanised	M5	20	1,8	4,2	8,5	3,5	2,5	4	1,88
K1160.405X25	steel	8.8	galvanised	M5	25	5	9	8,5	3,5	2,5	4	1,88
K1160.405X30	steel	8.8	galvanised	M5	30	10	14	8,5	3,5	2,5	4	1,88
K1160.406X10	steel	8.8	galvanised	M6	10	2,5	5,5	10	4	3	5	2,38
K1160.406X12	steel	8.8	galvanised	M6	12	2,5	5,5	10	4	3	5	2,38
K1160.406X16	steel	8.8	galvanised	M6	16	2,5	5,5	10	4	3	5	2,38
K1160.406X20	steel	8.8	galvanised	M6	20	2,5	5,5	10	4	3	5	2,38
K1160.406X25	steel	8.8	galvanised	M6	25	2,5	5,5	10	4	3	5	2,38
K1160.406X30	steel	8.8	galvanised	M6	30	7	12	10	4	3	5	2,38
K1160.406X35	steel	8.8	galvanised	M6	35	12	17	10	4	3	5	2,38
K1160.406X40	steel	8.8	galvanised	M6	40	17	22	10	4	3	5	2,38
K1160.406X45	steel	8.8	galvanised	M6	45	22	27	10	4	3	5	2,38
K1160.406X50	steel	8.8	galvanised	M6	50	27	32	10	4	3	5	2,38
K1160.406X60	steel	8.8	galvanised	M6	60	37	42	10	4	3	5	2,38
K1160.408X10	steel	8.8	galvanised	M8	10	0	6,25	13	5	4	6	2,88
K1160.408X12	steel	8.8	galvanised	M8	12	3,2	7	13	5	4	6	2,88
K1160.408X16	steel	8.8	galvanised	M8	16	3,2	7	13	5	4	6	2,88
K1160.408X20	steel	8.8	galvanised	M8	20	3,2	7	13	5	4	6	2,88
K1160.408X25	steel	8.8	galvanised	M8	25	3,2	7	13	5	4	6	2,88
K1160.408X30	steel	8.8	galvanised	M8	30	3,2	7	13	5	4	6	2,88
K1160.408X35	steel	8.8	galvanised	M8	35	6,75	13	13	5	4	6	2,88
K1160.408X40	steel	8.8	galvanised	M8	40	11,75	18	13	5	4	6	2,88
K1160.408X45	steel	8.8	galvanised	M8	45	16,75	23	13	5	4	6	2,88
K1160.408X50	steel	8.8	galvanised	M8	50	21,75	28	13	5	4	6	2,88
K1160.408X60	steel	8.8	galvanised	M8	60	31,75	38	13	5	4	6	2,88
K1160.408X70	steel	8.8	galvanised	M8	70	41,75	48	13	5	4	6	2,88
K1160.408X80	steel	8.8	galvanised	M8	80	51,75	58	13	5	4	6	2,88
K1160.410X20	steel	8.8	galvanised	M10	20	3,5	8	16	6,5	5	8	3,35
K1160.410X25	steel	8.8	galvanised	M10	25	3,5	8	16	6,5	5	8	3,35
K1160.410X30	steel	8.8	galvanised	M10	30	3,5	8	16	6,5	5	8	3,35
K1160.410X35	steel	8.8	galvanised	M10	35	3,5	8	16	6,5	5	8	3,35
K1160.410X40	steel	8.8	galvanised	M10	40	6,5	14	16	6,5	5	8	3,35
K1160.410X45	steel	8.8	galvanised	M10	45	11,5	19	16	6,5	5	8	3,35
K1160.410X50	steel	8.8	galvanised	M10	50	16,5	24	16	6,5	5	8	3,35
K1160.410X60	steel	8.8	galvanised	M10	60	26,5	34	16	6,5	5	8	3,35
K1160.410X70	steel	8.8	galvanised	M10	70	36,5	44	16	6,5	5	8	3,35
K1160.410X80	steel	8.8	galvanised	M10	80	46,5	54	16	6,5	5	8	3,35
K1160.410X90	steel	8.8	galvanised	M10	90	56,5	64	16	6,5	5	8	3,35
K1160.410X100	steel	8.8	galvanised	M10	100	66,5	74	16	6,5	5	8	3,35
K1160.412X20	steel	8.8	galvanised	M12	20	4,2	9,5	18	7,5	6	10	3,85
K1160.412X25	steel	8.8	galvanised	M12	25	4,2	9,5	18	7,5	6	10	3,85
K1160.412X30	steel	8.8	galvanised	M12	30	4,2	9,5	18	7,5	6	10	3,85
K1160.412X35	steel	8.8	galvanised	M12	35	4,2	9,5	18	7,5	6	10	3,85
K1160.412X40	steel	8.8	galvanised	M12	40	4,2	9,5	18	7,5	6	10	3,85
K1160.412X45	steel	8.8	galvanised	M12	45	6,5	15	18	7,5	6	10	3,85
K1160.412X50	steel	8.8	galvanised	M12	50	11,5	20	18	7,5	6	10	3,85
K1160.412X60	steel	8.8	galvanised	M12	60	21,5	30	18	7,5	6	10	3,85
K1160.412X70	steel	8.8	galvanised	M12	70	31,5	40	18	7,5	6	10	3,85
K1160.412X80	steel	8.8	galvanised	M12	80	41,5	50	18	7,5	6	10	3,85
K1160.412X90	steel	8.8	galvanised	M12	90	51,5	60	18	7,5	6	10	3,85
K1160.412X100	steel	8.8	galvanised	M12	100	61,5	70	18	7,5	6	10	3,85
K1160.412X110	steel	8.8	galvanised	M12	110	71,5	80	18	7,5	6	10	3,85
K1160.412X120	steel	8.8	galvanised	M12	120	81,5	90	18	7,5	6	10	3,85

Socket head screws with low head DIN 6912

Overview of items

Order No.	Main material	Grade	Surface finish body	D	L	Ls min.	Lg max.	DK	K	D1	SW	T
K1160.416X30	steel	8.8	galvanised	M16	30	5	11	24	10	8	14	5,35
K1160.416X35	steel	8.8	galvanised	M16	35	5	11	24	10	8	14	5,35
K1160.416X40	steel	8.8	galvanised	M16	40	5	11	24	10	8	14	5,35
K1160.416X45	steel	8.8	galvanised	M16	45	5	11	24	10	8	14	5,35
K1160.416X50	steel	8.8	galvanised	M16	50	5	11	24	10	8	14	5,35
K1160.416X60	steel	8.8	galvanised	M16	60	12	22	24	10	8	14	5,35
K1160.416X70	steel	8.8	galvanised	M16	70	22	32	24	10	8	14	5,35
K1160.416X80	steel	8.8	galvanised	M16	80	32	42	24	10	8	14	5,35
K1160.416X90	steel	8.8	galvanised	M16	90	42	52	24	10	8	14	5,35
K1160.416X100	steel	8.8	galvanised	M16	100	52	62	24	10	8	14	5,35
K1160.416X110	steel	8.8	galvanised	M16	110	62	72	24	10	8	14	5,35
K1160.416X120	steel	8.8	galvanised	M16	120	72	82	24	10	8	14	5,35
K1160.420X40	steel	8.8	galvanised	M20	40	6,5	14	30	12	10	17	6,32
K1160.420X45	steel	8.8	galvanised	M20	45	6,5	14	30	12	10	17	6,32
K1160.420X50	steel	8.8	galvanised	M20	50	6,5	14	30	12	10	17	6,32
K1160.420X60	steel	8.8	galvanised	M20	60	6,5	14	30	12	10	17	6,32
K1160.420X70	steel	8.8	galvanised	M20	70	11,5	24	30	12	10	17	6,32
K1160.420X80	steel	8.8	galvanised	M20	80	21,5	34	30	12	10	17	6,32
K1160.420X90	steel	8.8	galvanised	M20	90	31,5	44	30	12	10	17	6,32
K1160.420X100	steel	8.8	galvanised	M20	100	41,5	54	30	12	10	17	6,32
K1160.420X110	steel	8.8	galvanised	M20	110	51,5	64	30	12	10	17	6,32
K1160.420X120	steel	8.8	galvanised	M20	120	61,5	74	30	12	10	17	6,32
K1160.306X10	steel	10.9	bright (black)	M6	10	2,5	5,5	10	4	3	5	2,38
K1160.306X12	steel	10.9	bright (black)	M6	12	2,5	5,5	10	4	3	5	2,38
K1160.306X16	steel	10.9	bright (black)	M6	16	2,5	5,5	10	4	3	5	2,38
K1160.306X20	steel	10.9	bright (black)	M6	20	2,5	5,5	10	4	3	5	2,38
K1160.306X25	steel	10.9	bright (black)	M6	25	2,5	5,5	10	4	3	5	2,38
K1160.306X30	steel	10.9	bright (black)	M6	30	7	12	10	4	3	5	2,38
K1160.306X35	steel	10.9	bright (black)	M6	35	12	17	10	4	3	5	2,38
K1160.306X40	steel	10.9	bright (black)	M6	40	17	22	10	4	3	5	2,38
K1160.308X16	steel	10.9	bright (black)	M8	16	3,2	7	13	5	4	6	2,88
K1160.308X20	steel	10.9	bright (black)	M8	20	3,2	7	13	5	4	6	2,88
K1160.308X30	steel	10.9	bright (black)	M8	30	3,2	7	13	5	4	6	2,88
K1160.308X35	steel	10.9	bright (black)	M8	35	6,75	13	13	5	4	6	2,88
K1160.308X40	steel	10.9	bright (black)	M8	40	11,75	18	13	5	4	6	2,88
K1160.308X45	steel	10.9	bright (black)	M8	45	16,75	23	13	5	4	6	2,88
K1160.308X50	steel	10.9	bright (black)	M8	50	21,75	28	13	5	4	6	2,88
K1160.308X60	steel	10.9	bright (black)	M8	60	31,75	38	13	5	4	6	2,88
K1160.310X20	steel	10.9	bright (black)	M10	20	3,5	8	16	6,5	5	8	3,35
K1160.310X25	steel	10.9	bright (black)	M10	25	3,5	8	16	6,5	5	8	3,35
K1160.310X35	steel	10.9	bright (black)	M10	35	3,5	8	16	6,5	5	8	3,35
K1160.310X40	steel	10.9	bright (black)	M10	40	6,5	14	16	6,5	5	8	3,35
K1160.310X45	steel	10.9	bright (black)	M10	45	11,5	19	16	6,5	5	8	3,35
K1160.310X50	steel	10.9	bright (black)	M10	50	16,5	24	16	6,5	5	8	3,35
K1160.310X60	steel	10.9	bright (black)	M10	60	26,5	34	16	6,5	5	8	3,35
K1160.312X25	steel	10.9	bright (black)	M12	25	4,2	9,5	18	7,5	6	10	3,85
K1160.312X35	steel	10.9	bright (black)	M12	35	4,2	9,5	18	7,5	6	10	3,85
K1160.312X45	steel	10.9	bright (black)	M12	45	6,5	15	18	7,5	6	10	3,85
K1160.312X50	steel	10.9	bright (black)	M12	50	11,5	20	18	7,5	6	10	3,85
K1160.312X60	steel	10.9	bright (black)	M12	60	21,5	30	18	7,5	6	10	3,85
K1160.316X30	steel	10.9	bright (black)	M16	30	5	11	24	10	8	14	5,35
K1160.316X35	steel	10.9	bright (black)	M16	35	5	11	24	10	8	14	5,35
K1160.316X40	steel	10.9	bright (black)	M16	40	5	11	24	10	8	14	5,35
K1160.316X45	steel	10.9	bright (black)	M16	45	5	11	24	10	8	14	5,35
K1160.316X60	steel	10.9	bright (black)	M16	60	12	22	24	10	8	14	5,35
K1160.316X50	steel	10.9	bright (black)	M16	50	5	11	24	10	8	14	5,35
K1160.316X70	steel	10.9	bright (black)	M16	70	22	32	24	10	8	14	5,35
K1160.316X80	steel	10.9	bright (black)	M16	80	32	42	24	10	8	14	5,35
K1160.320X40	steel	10.9	bright (black)	M20	40	6,5	14	30	12	10	17	6,32
K1160.320X50	steel	10.9	bright (black)	M20	50	6,5	14	30	12	10	17	6,32
K1160.320X60	steel	10.9	bright (black)	M20	60	6,5	14	30	12	10	17	6,32
K1160.320X70	steel	10.9	bright (black)	M20	70	11,5	24	30	12	10	17	6,32

Socket head screws with low head DIN 6912

Overview of items

Order No.	Main material	Grade	Surface finish body	D	L	Ls min.	Lg max.	DK	K	D1	SW	T
K1160.104X10	stainless steel A2	70	bright	M4	10	1,4	3,5	7	2,8	2	3	1,48
K1160.104X12	stainless steel A2	70	bright	M4	12	1,4	3,5	7	2,8	2	3	1,48
K1160.104X16	stainless steel A2	70	bright	M4	16	1,4	3,5	7	2,8	2	3	1,48
K1160.104X20	stainless steel A2	70	bright	M4	20	2,5	6	7	2,8	2	3	1,48
K1160.104X25	stainless steel A2	70	bright	M4	25	4,5	11	7	2,8	2	3	1,48
K1160.105X10	stainless steel A2	70	bright	M5	10	1,8	4,2	8,5	3,5	2,5	4	1,88
K1160.105X12	stainless steel A2	70	bright	M5	12	1,8	4,2	8,5	3,5	2,5	4	1,88
K1160.105X16	stainless steel A2	70	bright	M5	16	1,8	4,2	8,5	3,5	2,5	4	1,88
K1160.105X20	stainless steel A2	70	bright	M5	20	1,8	4,2	8,5	3,5	2,5	4	1,88
K1160.105X25	stainless steel A2	70	bright	M5	25	5	9	8,5	3,5	2,5	4	1,88
K1160.105X30	stainless steel A2	70	bright	M5	30	10	14	8,5	3,5	2,5	4	1,88
K1160.106X10	stainless steel A2	70	bright	M6	10	2,5	5,5	10	4	3	5	2,38
K1160.106X12	stainless steel A2	70	bright	M6	12	2,5	5,5	10	4	3	5	2,38
K1160.106X16	stainless steel A2	70	bright	M6	16	2,5	5,5	10	4	3	5	2,38
K1160.106X20	stainless steel A2	70	bright	M6	20	2,5	5,5	10	4	3	5	2,38
K1160.106X25	stainless steel A2	70	bright	M6	25	2,5	5,5	10	4	3	5	2,38
K1160.106X30	stainless steel A2	70	bright	M6	30	7	12	10	4	3	5	2,38
K1160.106X35	stainless steel A2	70	bright	M6	35	12	17	10	4	3	5	2,38
K1160.106X40	stainless steel A2	70	bright	M6	40	17	22	10	4	3	5	2,38
K1160.106X45	stainless steel A2	70	bright	M6	45	22	27	10	4	3	5	2,38
K1160.106X50	stainless steel A2	70	bright	M6	50	27	32	10	4	3	5	2,38
K1160.106X60	stainless steel A2	70	bright	M6	60	37	42	10	4	3	5	2,38
K1160.108X10	stainless steel A2	70	bright	M8	10	0	6,25	13	5	4	6	2,88
K1160.108X12	stainless steel A2	70	bright	M8	12	3,2	7	13	5	4	6	2,88
K1160.108X16	stainless steel A2	70	bright	M8	16	3,2	7	13	5	4	6	2,88
K1160.108X20	stainless steel A2	70	bright	M8	20	3,2	7	13	5	4	6	2,88
K1160.108X25	stainless steel A2	70	bright	M8	25	3,2	7	13	5	4	6	2,88
K1160.108X30	stainless steel A2	70	bright	M8	30	3,2	7	13	5	4	6	2,88
K1160.108X35	stainless steel A2	70	bright	M8	35	6,75	13	13	5	4	6	2,88
K1160.108X40	stainless steel A2	70	bright	M8	40	11,75	18	13	5	4	6	2,88
K1160.108X45	stainless steel A2	70	bright	M8	45	16,75	23	13	5	4	6	2,88
K1160.108X50	stainless steel A2	70	bright	M8	50	21,75	28	13	5	4	6	2,88
K1160.108X60	stainless steel A2	70	bright	M8	60	31,75	38	13	5	4	6	2,88
K1160.108X70	stainless steel A2	70	bright	M8	70	41,75	48	13	5	4	6	2,88
K1160.110X16	stainless steel A2	70	bright	M10	16	3,5	8	16	6,5	5	8	3,35
K1160.110X20	stainless steel A2	70	bright	M10	20	3,5	8	16	6,5	5	8	3,35
K1160.110X25	stainless steel A2	70	bright	M10	25	3,5	8	16	6,5	5	8	3,35
K1160.110X30	stainless steel A2	70	bright	M10	30	3,5	8	16	6,5	5	8	3,35
K1160.110X35	stainless steel A2	70	bright	M10	35	3,5	8	16	6,5	5	8	3,35
K1160.110X40	stainless steel A2	70	bright	M10	40	6,5	14	16	6,5	5	8	3,35
K1160.110X45	stainless steel A2	70	bright	M10	45	11,5	19	16	6,5	5	8	3,35
K1160.110X50	stainless steel A2	70	bright	M10	50	16,5	24	16	6,5	5	8	3,35
K1160.110X60	stainless steel A2	70	bright	M10	60	26,5	34	16	6,5	5	8	3,35
K1160.110X70	stainless steel A2	70	bright	M10	70	36,5	44	16	6,5	5	8	3,35
K1160.112X20	stainless steel A2	70	bright	M12	20	4,2	9,5	18	7,5	6	10	3,85
K1160.112X25	stainless steel A2	70	bright	M12	25	4,2	9,5	18	7,5	6	10	3,85
K1160.112X30	stainless steel A2	70	bright	M12	30	4,2	9,5	18	7,5	6	10	3,85
K1160.112X35	stainless steel A2	70	bright	M12	35	4,2	9,5	18	7,5	6	10	3,85
K1160.112X40	stainless steel A2	70	bright	M12	40	4,2	9,5	18	7,5	6	10	3,85
K1160.112X45	stainless steel A2	70	bright	M12	45	6,5	15	18	7,5	6	10	3,85
K1160.112X50	stainless steel A2	70	bright	M12	50	11,5	20	18	7,5	6	10	3,85
K1160.112X60	stainless steel A2	70	bright	M12	60	21,5	30	18	7,5	6	10	3,85
K1160.112X70	stainless steel A2	70	bright	M12	70	31,5	40	18	7,5	6	10	3,85
K1160.604X10	stainless steel A4	70	bright	M4	10	1,4	3,5	7	2,8	2	3	1,48
K1160.604X12	stainless steel A4	70	bright	M4	12	1,4	3,5	7	2,8	2	3	1,48
K1160.604X16	stainless steel A4	70	bright	M4	16	1,4	3,5	7	2,8	2	3	1,48
K1160.604X20	stainless steel A4	70	bright	M4	20	2,5	6	7	2,8	2	3	1,48
K1160.604X25	stainless steel A4	70	bright	M4	25	7,5	11	7	2,8	2	3	1,48
K1160.605X10	stainless steel A4	70	bright	M5	10	1,8	4,2	8,5	3,5	2,5	4	1,88
K1160.605X12	stainless steel A4	70	bright	M5	12	1,8	4,2	8,5	3,5	2,5	4	1,88
K1160.605X16	stainless steel A4	70	bright	M5	16	1,8	4,2	8,5	3,5	2,5	4	1,88
K1160.605X20	stainless steel A4	70	bright	M5	20	1,8	4,2	8,5	3,5	2,5	4	1,88

Socket head screws with low head DIN 6912

Overview of items

Order No.	Main material	Grade	Surface finish body	D	L	Ls min.	Lg max.	DK	K	D1	SW	T
K1160.605X25	stainless steel A4	70	bright	M5	25	5	9	8,5	3,5	2,5	4	1,88
K1160.605X30	stainless steel A4	70	bright	M5	30	10	14	8,5	3,5	2,5	4	1,88
K1160.606X10	stainless steel A4	70	bright	M6	10	2,5	5,5	10	4	3	5	2,38
K1160.606X12	stainless steel A4	70	bright	M6	12	2,5	5,5	10	4	3	5	2,38
K1160.606X16	stainless steel A4	70	bright	M6	16	2,5	5,5	10	4	3	5	2,38
K1160.606X20	stainless steel A4	70	bright	M6	20	2,5	5,5	10	4	3	5	2,38
K1160.606X25	stainless steel A4	70	bright	M6	25	2,5	5,5	10	4	3	5	2,38
K1160.606X30	stainless steel A4	70	bright	M6	30	7	12	10	4	3	5	2,38
K1160.606X35	stainless steel A4	70	bright	M6	35	12	17	10	4	3	5	2,38
K1160.606X40	stainless steel A4	70	bright	M6	40	17	22	10	4	3	5	2,38
K1160.606X45	stainless steel A4	70	bright	M6	45	22	27	10	4	3	5	2,38
K1160.606X50	stainless steel A4	70	bright	M6	50	27	32	10	4	3	5	2,38
K1160.606X60	stainless steel A4	70	bright	M6	60	37	42	10	4	3	5	2,38
K1160.608X10	stainless steel A4	70	bright	M8	10	0	6,25	13	5	4	6	2,88
K1160.608X12	stainless steel A4	70	bright	M8	12	3,2	7	13	5	4	6	2,88
K1160.608X16	stainless steel A4	70	bright	M8	16	3,2	7	13	5	4	6	2,88
K1160.608X20	stainless steel A4	70	bright	M8	20	3,2	7	13	5	4	6	2,88
K1160.608X25	stainless steel A4	70	bright	M8	25	3,2	7	13	5	4	6	2,88
K1160.608X30	stainless steel A4	70	bright	M8	30	3,2	7	13	5	4	6	2,88
K1160.608X35	stainless steel A4	70	bright	M8	35	6,75	13	13	5	4	6	2,88
K1160.608X40	stainless steel A4	70	bright	M8	40	11,75	18	13	5	4	6	2,88
K1160.608X45	stainless steel A4	70	bright	M8	45	16,75	23	13	5	4	6	2,88
K1160.608X50	stainless steel A4	70	bright	M8	50	21,75	28	13	5	4	6	2,88
K1160.608X60	stainless steel A4	70	bright	M8	60	31,75	38	13	5	4	6	2,88
K1160.608X70	stainless steel A4	70	bright	M8	70	41,75	48	13	5	4	6	2,88
K1160.610X16	stainless steel A4	70	bright	M10	16	3,5	8	16	6,5	5	8	3,35
K1160.610X20	stainless steel A4	70	bright	M10	20	3,5	8	16	6,5	5	8	3,35
K1160.610X25	stainless steel A4	70	bright	M10	25	3,5	8	16	6,5	5	8	3,35
K1160.610X30	stainless steel A4	70	bright	M10	30	3,5	8	16	6,5	5	8	3,35
K1160.610X35	stainless steel A4	70	bright	M10	35	3,5	8	16	6,5	5	8	3,35
K1160.610X40	stainless steel A4	70	bright	M10	40	6,5	14	16	6,5	5	8	3,35
K1160.610X45	stainless steel A4	70	bright	M10	45	11,5	19	16	6,5	5	8	3,35
K1160.610X50	stainless steel A4	70	bright	M10	50	16,5	24	16	6,5	5	8	3,35
K1160.610X60	stainless steel A4	70	bright	M10	60	26,5	34	16	6,5	5	8	3,35
K1160.610X70	stainless steel A4	70	bright	M10	70	36,5	44	16	6,5	5	8	3,35
K1160.612X20	stainless steel A4	70	bright	M12	20	4,2	9,5	18	7,5	6	10	3,85
K1160.612X25	stainless steel A4	70	bright	M12	25	4,2	9,5	18	7,5	6	10	3,85
K1160.612X30	stainless steel A4	70	bright	M12	30	4,2	9,5	18	7,5	6	10	3,85
K1160.612X35	stainless steel A4	70	bright	M12	35	4,2	9,5	18	7,5	6	10	3,85
K1160.612X40	stainless steel A4	70	bright	M12	40	4,2	9,5	18	7,5	6	10	3,85
K1160.612X45	stainless steel A4	70	bright	M12	45	6,5	15	18	7,5	6	10	3,85
K1160.612X50	stainless steel A4	70	bright	M12	50	11,5	20	18	7,5	6	10	3,85
K1160.612X70	stainless steel A4	70	bright	M12	70	31,5	40	18	7,5	6	10	3,85