

Oil level gauges long version

Item description/product images



Description

Material:

Housing aluminium.
 Tube polycarbonate.
 Caps polyamide.
 O-ring and flat seal NBR, Shore 70.
 Screw and hex. nut steel.

Version:

Viewing glass transparent.
 Screws and nuts electro zinc-plated.

Note:

The oil level gauges can either be fastened as shown in the illustration or directly in the tapped hole. Centre distance for the fastening holes = $L1 \pm 0.3$. The maximum operating temperature is 90 °C. The maximum pressure is 1 bar. The maximum tightening torque of the fastening screws is 5 Nm.

Drawing reference:

- 1) flat seal
- 2) O-ring

Drawings

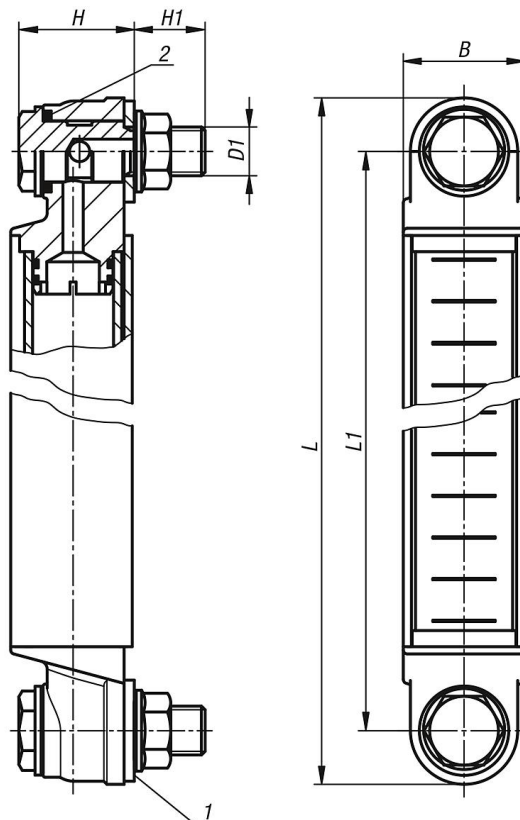

Oil level gauges long version

Overview of items

Oil level gauges long version

Order No.	B	D1	H	H1	L	L1
K1100.1300	30	M12	30	16,5	325	300
K1100.1400	30	M12	30	16,5	425	400
K1100.1500	30	M12	30	16,5	525	500