

Roller track steel

Item description/product images

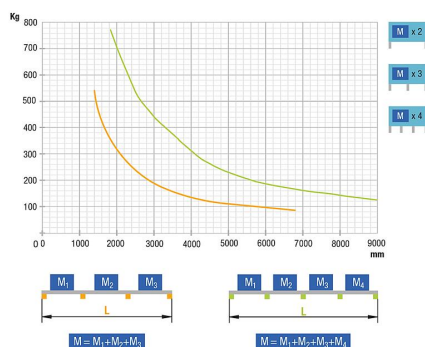
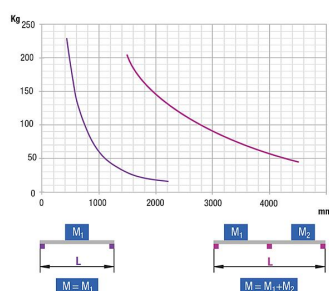

Description

Material:

Roller rail profile: steel.

Roller: plastic PP.

Axle: steel.

Version:

Roller rail profile: galvanised.

Roller: grey similar to RAL 7042. ESD version black.

Axle: galvanised.

Note:

Durable and smooth-running roller rails. The system is fully assembled. The roller rail profile contains plastic rollers mounted on steel axles. Narrow centre distances guarantee smooth, trouble-free running. If required, the sheet steel roller rail profile can simply be cut to the desired length.

Fixed and variable brackets are available as accessories. This bracket enables direct connection to round tubes or profile tubes $\varnothing 30$ and to aluminium profiles with a grid dimension of 40 mm.

Form A: without wheel flange.

Form B: with wheel flange.

Roller track steel

Drawings

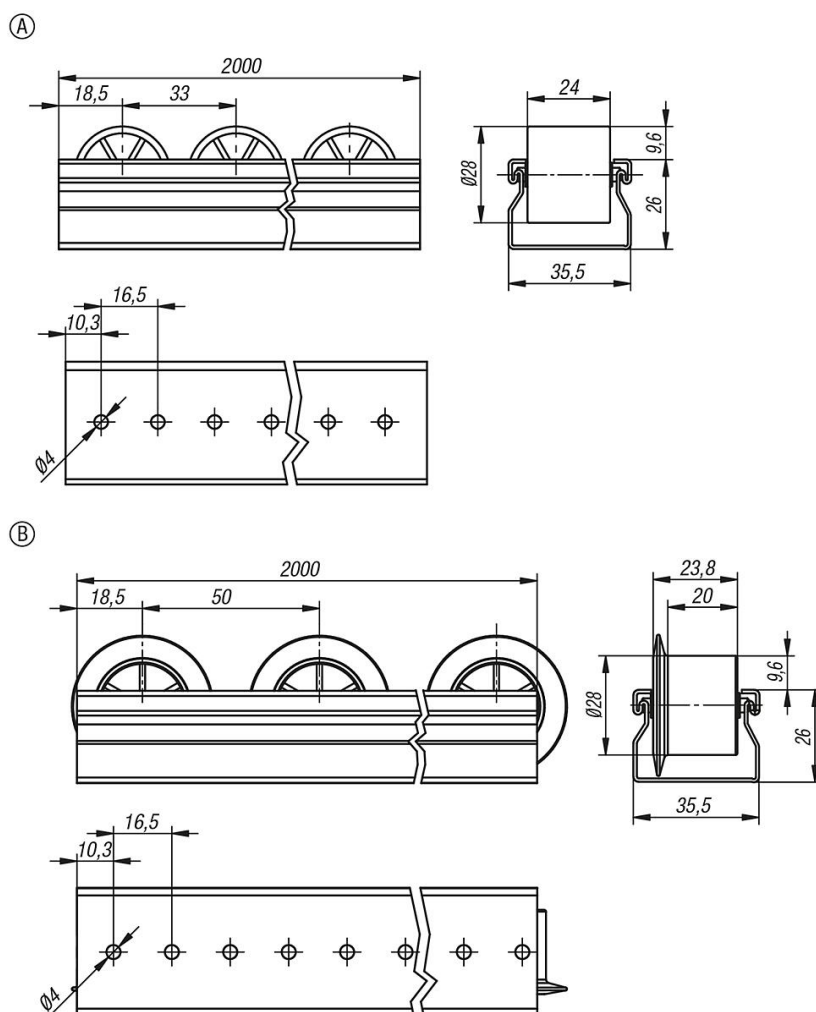

Overview of items

Roller track steel

Order No.	Form	Form definition	Component colour	L	ESD electrostatic discharging
K2135.120X2000	A	without wheel flange	grey	2000	no
K2135.111X2000	A	without wheel flange	black	2000	yes
K2135.220X2000	B	with wheel flange	grey	2000	no
K2135.211X2000	B	with wheel flange	black	2000	yes