

Shoulder screws similar to ISO 7379

Item description/product images



Description

Material:

Steel or stainless steel A2.

Version:

Grade 12.9. Shaft OD ground and bright.

Bright stainless steel or tempered steel.

Note:

Hexagon socket head shoulder screws are precision construction elements for many applications. As they can simplify complicated constructions, they are frequently chosen as the most cost-effective solution. Shoulder screws provide the decisive rationalising effect required today.

Drawings

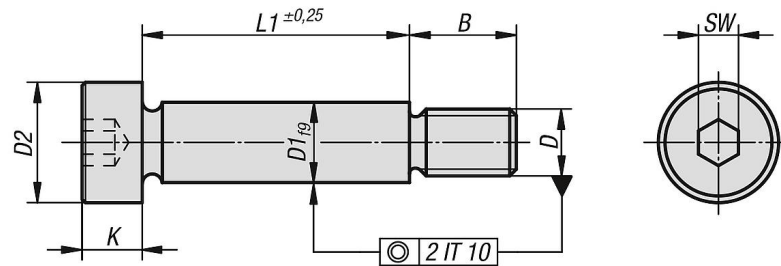

Overview of items

Shoulder screws similar to ISO 7379

| Order No. | Main material | D1 | D | D2 | B | K | SW | L1 |
|-------------|---------------|----|----|----|-----|-----|-----|----|
| K0705.04X04 | steel | 4 | M3 | 7 | 7 | 3 | 2 | 4 |
| K0705.04X05 | steel | 4 | M3 | 7 | 7 | 3 | 2 | 5 |
| K0705.04X06 | steel | 4 | M3 | 7 | 7 | 3 | 2 | 6 |
| K0705.04X08 | steel | 4 | M3 | 7 | 7 | 3 | 2 | 8 |
| K0705.04X10 | steel | 4 | M3 | 7 | 7 | 3 | 2 | 10 |
| K0705.04X12 | steel | 4 | M3 | 7 | 7 | 3 | 2 | 12 |
| K0705.04X16 | steel | 4 | M3 | 7 | 7 | 3 | 2 | 16 |
| K0705.04X20 | steel | 4 | M3 | 7 | 7 | 3 | 2 | 20 |
| K0705.04X25 | steel | 4 | M3 | 7 | 7 | 3 | 2 | 25 |
| K0705.04X30 | steel | 4 | M3 | 7 | 7 | 3 | 2 | 30 |
| K0705.05X05 | steel | 5 | M4 | 9 | 8 | 4 | 2,5 | 5 |
| K0705.05X06 | steel | 5 | M4 | 9 | 8 | 4 | 2,5 | 6 |
| K0705.05X12 | steel | 5 | M4 | 9 | 8 | 4 | 2,5 | 12 |
| K0705.05X16 | steel | 5 | M4 | 9 | 8 | 4 | 2,5 | 16 |
| K0705.05X20 | steel | 5 | M4 | 9 | 8 | 4 | 2,5 | 20 |
| K0705.05X25 | steel | 5 | M4 | 9 | 8 | 4 | 2,5 | 25 |
| K0705.05X08 | steel | 5 | M4 | 9 | 8 | 4 | 2,5 | 8 |
| K0705.05X10 | steel | 5 | M4 | 9 | 8 | 4 | 2,5 | 10 |
| K0705.05X30 | steel | 5 | M4 | 9 | 8 | 4 | 2,5 | 30 |
| K0705.05X40 | steel | 5 | M4 | 9 | 8 | 4 | 2,5 | 40 |
| K0705.06X10 | steel | 6 | M5 | 10 | 9,5 | 4,5 | 3 | 10 |
| K0705.06X12 | steel | 6 | M5 | 10 | 9,5 | 4,5 | 3 | 12 |
| K0705.06X16 | steel | 6 | M5 | 10 | 9,5 | 4,5 | 3 | 16 |

Shoulder screws similar to ISO 7379

Overview of items

| Order No. | Main material | D1 | D | D2 | B | K | SW | L1 |
|--------------|---------------|----|-----|----|-----|-----|----|-----|
| K0705.06X20 | steel | 6 | M5 | 10 | 9,5 | 4,5 | 3 | 20 |
| K0705.06X25 | steel | 6 | M5 | 10 | 9,5 | 4,5 | 3 | 25 |
| K0705.06X30 | steel | 6 | M5 | 10 | 9,5 | 4,5 | 3 | 30 |
| K0705.06X35 | steel | 6 | M5 | 10 | 9,5 | 4,5 | 3 | 35 |
| K0705.06X40 | steel | 6 | M5 | 10 | 9,5 | 4,5 | 3 | 40 |
| K0705.06X45 | steel | 6 | M5 | 10 | 9,5 | 4,5 | 3 | 45 |
| K0705.06X50 | steel | 6 | M5 | 10 | 9,5 | 4,5 | 3 | 50 |
| K0705.06X55 | steel | 6 | M5 | 10 | 9,5 | 4,5 | 3 | 55 |
| K0705.06X60 | steel | 6 | M5 | 10 | 9,5 | 4,5 | 3 | 60 |
| K0705.06X65 | steel | 6 | M5 | 10 | 9,5 | 4,5 | 3 | 65 |
| K0705.06X70 | steel | 6 | M5 | 10 | 9,5 | 4,5 | 3 | 70 |
| K0705.06X80 | steel | 6 | M5 | 10 | 9,5 | 4,5 | 3 | 80 |
| K0705.08X16 | steel | 8 | M6 | 13 | 11 | 5,5 | 4 | 16 |
| K0705.08X20 | steel | 8 | M6 | 13 | 11 | 5,5 | 4 | 20 |
| K0705.08X25 | steel | 8 | M6 | 13 | 11 | 5,5 | 4 | 25 |
| K0705.08X30 | steel | 8 | M6 | 13 | 11 | 5,5 | 4 | 30 |
| K0705.08X40 | steel | 8 | M6 | 13 | 11 | 5,5 | 4 | 40 |
| K0705.08X45 | steel | 8 | M6 | 13 | 11 | 5,5 | 4 | 45 |
| K0705.08X50 | steel | 8 | M6 | 13 | 11 | 5,5 | 4 | 50 |
| K0705.08X55 | steel | 8 | M6 | 13 | 11 | 5,5 | 4 | 55 |
| K0705.08X60 | steel | 8 | M6 | 13 | 11 | 5,5 | 4 | 60 |
| K0705.08X65 | steel | 8 | M6 | 13 | 11 | 5,5 | 4 | 65 |
| K0705.08X70 | steel | 8 | M6 | 13 | 11 | 5,5 | 4 | 70 |
| K0705.08X80 | steel | 8 | M6 | 13 | 11 | 5,5 | 4 | 80 |
| K0705.08X90 | steel | 8 | M6 | 13 | 11 | 5,5 | 4 | 90 |
| K0705.08X100 | steel | 8 | M6 | 13 | 11 | 5,5 | 4 | 100 |
| K0705.10X16 | steel | 10 | M8 | 16 | 13 | 7 | 5 | 16 |
| K0705.10X20 | steel | 10 | M8 | 16 | 13 | 7 | 5 | 20 |
| K0705.10X25 | steel | 10 | M8 | 16 | 13 | 7 | 5 | 25 |
| K0705.10X30 | steel | 10 | M8 | 16 | 13 | 7 | 5 | 30 |
| K0705.10X35 | steel | 10 | M8 | 16 | 13 | 7 | 5 | 35 |
| K0705.10X40 | steel | 10 | M8 | 16 | 13 | 7 | 5 | 40 |
| K0705.10X45 | steel | 10 | M8 | 16 | 13 | 7 | 5 | 45 |
| K0705.10X50 | steel | 10 | M8 | 16 | 13 | 7 | 5 | 50 |
| K0705.10X55 | steel | 10 | M8 | 16 | 13 | 7 | 5 | 55 |
| K0705.10X60 | steel | 10 | M8 | 16 | 13 | 7 | 5 | 60 |
| K0705.10X65 | steel | 10 | M8 | 16 | 13 | 7 | 5 | 65 |
| K0705.10X70 | steel | 10 | M8 | 16 | 13 | 7 | 5 | 70 |
| K0705.10X80 | steel | 10 | M8 | 16 | 13 | 7 | 5 | 80 |
| K0705.10X90 | steel | 10 | M8 | 16 | 13 | 7 | 5 | 90 |
| K0705.10X100 | steel | 10 | M8 | 16 | 13 | 7 | 5 | 100 |
| K0705.12X100 | steel | 12 | M10 | 18 | 16 | 9 | 6 | 100 |
| K0705.12X16 | steel | 12 | M10 | 18 | 16 | 9 | 6 | 16 |
| K0705.12X20 | steel | 12 | M10 | 18 | 16 | 9 | 6 | 20 |
| K0705.12X25 | steel | 12 | M10 | 18 | 16 | 9 | 6 | 25 |
| K0705.12X30 | steel | 12 | M10 | 18 | 16 | 9 | 6 | 30 |
| K0705.12X35 | steel | 12 | M10 | 18 | 16 | 8 | 6 | 35 |
| K0705.12X40 | steel | 12 | M10 | 18 | 16 | 9 | 6 | 40 |
| K0705.12X45 | steel | 12 | M10 | 18 | 16 | 8 | 6 | 45 |
| K0705.12X50 | steel | 12 | M10 | 18 | 16 | 9 | 6 | 50 |
| K0705.12X55 | steel | 12 | M10 | 18 | 16 | 8 | 6 | 55 |
| K0705.12X60 | steel | 12 | M10 | 18 | 16 | 9 | 6 | 60 |
| K0705.12X65 | steel | 12 | M10 | 18 | 16 | 8 | 6 | 65 |
| K0705.12X70 | steel | 12 | M10 | 18 | 16 | 9 | 6 | 70 |
| K0705.12X80 | steel | 12 | M10 | 18 | 16 | 9 | 6 | 80 |
| K0705.12X90 | steel | 12 | M10 | 18 | 16 | 9 | 6 | 90 |
| K0705.16X100 | steel | 16 | M12 | 24 | 18 | 11 | 8 | 100 |
| K0705.16X120 | steel | 16 | M12 | 24 | 18 | 11 | 8 | 120 |
| K0705.16X25 | steel | 16 | M12 | 24 | 18 | 11 | 8 | 25 |
| K0705.16X30 | steel | 16 | M12 | 24 | 18 | 11 | 8 | 30 |
| K0705.16X35 | steel | 16 | M12 | 24 | 18 | 11 | 8 | 35 |
| K0705.16X40 | steel | 16 | M12 | 24 | 18 | 11 | 8 | 40 |

Shoulder screws similar to ISO 7379

Overview of items

| Order No. | Main material | D1 | D | D2 | B | K | SW | L1 |
|--------------|--------------------|----|-----|----|-----|-----|-----|-----|
| K0705.16X45 | steel | 16 | M12 | 24 | 18 | 11 | 8 | 45 |
| K0705.16X50 | steel | 16 | M12 | 24 | 18 | 11 | 8 | 50 |
| K0705.16X55 | steel | 16 | M12 | 24 | 18 | 11 | 8 | 55 |
| K0705.16X60 | steel | 16 | M12 | 24 | 18 | 11 | 8 | 60 |
| K0705.16X65 | steel | 16 | M12 | 24 | 18 | 11 | 8 | 65 |
| K0705.16X70 | steel | 16 | M12 | 24 | 18 | 11 | 8 | 70 |
| K0705.16X80 | steel | 16 | M12 | 24 | 18 | 11 | 8 | 80 |
| K0705.16X90 | steel | 16 | M12 | 24 | 18 | 11 | 8 | 90 |
| K0705.20X30 | steel | 20 | M16 | 30 | 22 | 14 | 10 | 30 |
| K0705.20X35 | steel | 20 | M16 | 30 | 22 | 14 | 10 | 35 |
| K0705.20X40 | steel | 20 | M16 | 30 | 22 | 14 | 10 | 40 |
| K0705.20X45 | steel | 20 | M16 | 30 | 22 | 14 | 10 | 45 |
| K0705.20X50 | steel | 20 | M16 | 30 | 22 | 14 | 10 | 50 |
| K0705.20X55 | steel | 20 | M16 | 30 | 22 | 14 | 10 | 55 |
| K0705.20X60 | steel | 20 | M16 | 30 | 22 | 14 | 10 | 60 |
| K0705.20X65 | steel | 20 | M16 | 30 | 22 | 14 | 10 | 65 |
| K0705.20X70 | steel | 20 | M16 | 30 | 22 | 14 | 10 | 70 |
| K0705.20X80 | steel | 20 | M16 | 30 | 22 | 14 | 10 | 80 |
| K0705.20X90 | steel | 20 | M16 | 30 | 22 | 14 | 10 | 90 |
| K0705.20X100 | steel | 20 | M16 | 30 | 22 | 14 | 10 | 100 |
| K0705.20X120 | steel | 20 | M16 | 30 | 22 | 14 | 10 | 120 |
| K0705.24X50 | steel | 24 | M20 | 36 | 27 | 16 | 12 | 50 |
| K0705.24X55 | steel | 24 | M20 | 36 | 27 | 16 | 12 | 55 |
| K0705.24X60 | steel | 24 | M20 | 36 | 27 | 16 | 12 | 60 |
| K0705.24X65 | steel | 24 | M20 | 36 | 27 | 16 | 12 | 65 |
| K0705.24X70 | steel | 24 | M20 | 36 | 27 | 16 | 12 | 70 |
| K0705.24X80 | steel | 24 | M20 | 36 | 27 | 16 | 12 | 80 |
| K0705.24X90 | steel | 24 | M20 | 36 | 27 | 16 | 12 | 90 |
| K0705.24X100 | steel | 24 | M20 | 36 | 27 | 16 | 12 | 100 |
| K0705.104X04 | stainless steel A2 | 4 | M3 | 7 | 7 | 3 | 2 | 4 |
| K0705.104X05 | stainless steel A2 | 4 | M3 | 7 | 7 | 3 | 2 | 5 |
| K0705.104X06 | stainless steel A2 | 4 | M3 | 7 | 7 | 3 | 2 | 6 |
| K0705.104X08 | stainless steel A2 | 4 | M3 | 7 | 7 | 3 | 2 | 8 |
| K0705.104X10 | stainless steel A2 | 4 | M3 | 7 | 7 | 3 | 2 | 10 |
| K0705.104X12 | stainless steel A2 | 4 | M3 | 7 | 7 | 3 | 2 | 12 |
| K0705.104X16 | stainless steel A2 | 4 | M3 | 7 | 7 | 3 | 2 | 16 |
| K0705.104X20 | stainless steel A2 | 4 | M3 | 7 | 7 | 3 | 2 | 20 |
| K0705.105X05 | stainless steel A2 | 5 | M4 | 9 | 8 | 4 | 2,5 | 5 |
| K0705.105X06 | stainless steel A2 | 5 | M4 | 9 | 8 | 4 | 2,5 | 6 |
| K0705.105X08 | stainless steel A2 | 5 | M4 | 9 | 8 | 4 | 2,5 | 8 |
| K0705.105X10 | stainless steel A2 | 5 | M4 | 9 | 8 | 4 | 2,5 | 10 |
| K0705.105X12 | stainless steel A2 | 5 | M4 | 9 | 8 | 4 | 2,5 | 12 |
| K0705.105X16 | stainless steel A2 | 5 | M4 | 9 | 8 | 4 | 2,5 | 16 |
| K0705.105X20 | stainless steel A2 | 5 | M4 | 9 | 8 | 4 | 2,5 | 20 |
| K0705.105X25 | stainless steel A2 | 5 | M4 | 9 | 8 | 4 | 2,5 | 25 |
| K0705.105X30 | stainless steel A2 | 5 | M4 | 9 | 8 | 4 | 2,5 | 30 |
| K0705.105X40 | stainless steel A2 | 5 | M4 | 9 | 8 | 4 | 2,5 | 40 |
| K0705.106X10 | stainless steel A2 | 6 | M5 | 10 | 9,5 | 4,5 | 3 | 10 |
| K0705.106X12 | stainless steel A2 | 6 | M5 | 10 | 9,5 | 4,5 | 3 | 12 |
| K0705.106X16 | stainless steel A2 | 6 | M5 | 10 | 9,5 | 4,5 | 3 | 16 |
| K0705.106X20 | stainless steel A2 | 6 | M5 | 10 | 9,5 | 4,5 | 3 | 20 |
| K0705.106X25 | stainless steel A2 | 6 | M5 | 10 | 9,5 | 4,5 | 3 | 25 |
| K0705.106X30 | stainless steel A2 | 6 | M5 | 10 | 9,5 | 4,5 | 3 | 30 |
| K0705.106X40 | stainless steel A2 | 6 | M5 | 10 | 9,5 | 4,5 | 3 | 40 |
| K0705.106X50 | stainless steel A2 | 6 | M5 | 10 | 9,5 | 4,5 | 3 | 50 |
| K0705.106X60 | stainless steel A2 | 6 | M5 | 10 | 9,5 | 4,5 | 3 | 60 |
| K0705.108X16 | stainless steel A2 | 8 | M6 | 13 | 11 | 5,5 | 4 | 16 |
| K0705.108X20 | stainless steel A2 | 8 | M6 | 13 | 11 | 5,5 | 4 | 20 |
| K0705.108X25 | stainless steel A2 | 8 | M6 | 13 | 11 | 5,5 | 4 | 25 |
| K0705.108X30 | stainless steel A2 | 8 | M6 | 13 | 11 | 5,5 | 4 | 30 |
| K0705.108X40 | stainless steel A2 | 8 | M6 | 13 | 11 | 5,5 | 4 | 40 |
| K0705.108X50 | stainless steel A2 | 8 | M6 | 13 | 11 | 5,5 | 4 | 50 |

Shoulder screws similar to ISO 7379

Overview of items

| Order No. | Main material | D1 | D | D2 | B | K | SW | L1 |
|---------------|--------------------|----|-----|----|----|-----|----|-----|
| K0705.108X60 | stainless steel A2 | 8 | M6 | 13 | 11 | 5,5 | 4 | 60 |
| K0705.110X16 | stainless steel A2 | 10 | M8 | 16 | 13 | 7 | 5 | 16 |
| K0705.110X20 | stainless steel A2 | 10 | M8 | 16 | 13 | 7 | 5 | 20 |
| K0705.110X25 | stainless steel A2 | 10 | M8 | 16 | 13 | 7 | 5 | 25 |
| K0705.110X30 | stainless steel A2 | 10 | M8 | 16 | 13 | 7 | 5 | 30 |
| K0705.110X40 | stainless steel A2 | 10 | M8 | 16 | 13 | 7 | 5 | 40 |
| K0705.110X50 | stainless steel A2 | 10 | M8 | 16 | 13 | 7 | 5 | 50 |
| K0705.110X60 | stainless steel A2 | 10 | M8 | 16 | 13 | 7 | 5 | 60 |
| K0705.110X70 | stainless steel A2 | 10 | M8 | 16 | 13 | 7 | 5 | 70 |
| K0705.110X80 | stainless steel A2 | 10 | M8 | 16 | 13 | 7 | 5 | 80 |
| K0705.110X90 | stainless steel A2 | 10 | M8 | 16 | 13 | 7 | 5 | 90 |
| K0705.110X100 | stainless steel A2 | 10 | M8 | 16 | 13 | 7 | 5 | 100 |
| K0705.112X16 | stainless steel A2 | 12 | M10 | 18 | 16 | 9 | 6 | 16 |
| K0705.112X20 | stainless steel A2 | 12 | M10 | 18 | 16 | 9 | 6 | 20 |
| K0705.112X25 | stainless steel A2 | 12 | M10 | 18 | 16 | 9 | 6 | 25 |
| K0705.112X30 | stainless steel A2 | 12 | M10 | 18 | 16 | 9 | 6 | 30 |
| K0705.112X40 | stainless steel A2 | 12 | M10 | 18 | 16 | 9 | 6 | 40 |
| K0705.112X50 | stainless steel A2 | 12 | M10 | 18 | 16 | 9 | 6 | 50 |
| K0705.112X60 | stainless steel A2 | 12 | M10 | 18 | 16 | 9 | 6 | 60 |
| K0705.112X70 | stainless steel A2 | 12 | M10 | 18 | 16 | 9 | 6 | 70 |
| K0705.112X80 | stainless steel A2 | 12 | M10 | 18 | 16 | 9 | 6 | 80 |
| K0705.112X90 | stainless steel A2 | 12 | M10 | 18 | 16 | 9 | 6 | 90 |
| K0705.112X100 | stainless steel A2 | 12 | M10 | 18 | 16 | 9 | 6 | 100 |
| K0705.116X30 | stainless steel A2 | 16 | M12 | 24 | 18 | 11 | 8 | 30 |
| K0705.116X40 | stainless steel A2 | 16 | M12 | 24 | 18 | 11 | 8 | 40 |
| K0705.116X50 | stainless steel A2 | 16 | M12 | 24 | 18 | 11 | 8 | 50 |
| K0705.116X60 | stainless steel A2 | 16 | M12 | 24 | 18 | 11 | 8 | 60 |
| K0705.116X70 | stainless steel A2 | 16 | M12 | 24 | 18 | 11 | 8 | 70 |
| K0705.116X80 | stainless steel A2 | 16 | M12 | 24 | 18 | 11 | 8 | 80 |
| K0705.116X90 | stainless steel A2 | 16 | M12 | 24 | 18 | 11 | 8 | 90 |
| K0705.116X100 | stainless steel A2 | 16 | M12 | 24 | 18 | 11 | 8 | 100 |
| K0705.116X120 | stainless steel A2 | 16 | M12 | 24 | 18 | 11 | 8 | 120 |
| K0705.120X30 | stainless steel A2 | 20 | M16 | 30 | 22 | 14 | 10 | 30 |
| K0705.120X40 | stainless steel A2 | 20 | M16 | 30 | 22 | 14 | 10 | 40 |
| K0705.120X50 | stainless steel A2 | 20 | M16 | 30 | 22 | 14 | 10 | 50 |
| K0705.120X60 | stainless steel A2 | 20 | M16 | 30 | 22 | 14 | 10 | 60 |
| K0705.120X70 | stainless steel A2 | 20 | M16 | 30 | 22 | 14 | 10 | 70 |
| K0705.120X80 | stainless steel A2 | 20 | M16 | 30 | 22 | 14 | 10 | 80 |
| K0705.120X90 | stainless steel A2 | 20 | M16 | 30 | 22 | 14 | 10 | 90 |
| K0705.120X100 | stainless steel A2 | 20 | M16 | 30 | 22 | 14 | 10 | 100 |
| K0705.120X120 | stainless steel A2 | 20 | M16 | 30 | 22 | 14 | 10 | 120 |