

Bushes for tongues, zinc

Item description/product images



Description

Material:

Bushes zinc.

Note:

The bushes for tongues are used to connect swivel grips to tongues. With the aid of the bushes and in combination with the adapter for quarter-turn lock tongues K2272, the adapter for round rods K2271 or the bar lock for flat rods, a 1 or 3 point locking system can be created to secure e.g. switch cabinets.

Accessory:

K1114 Steel tongue for quarter-turn locks.

K2244 Steel tongue for quarter-turn locks.

K0523 Steel tongue for quarter-turn locks.

K2272 Plastic or zinc adapter for tongues.

K2279 Plastic or zinc bar lock for flat bars.

K2271 Steel, stainless steel or zinc adapter for rods

Drawings

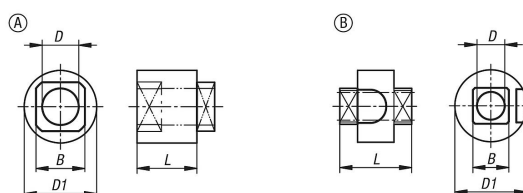

Overview of items

Bushes for tongues, zinc

Order No.	Form	B	D	D1	L
K2273.0611	A	8	6	11,8	12,6
K2273.0612	A	8	6	11,8	11
K2273.0615	B	7,9	6,1	16	15