

## Levelling feet plates plastic

### Item description/product images



### Description

**Material:**

Plates, thermoplastic, fibreglass reinforced.

Anti-slip plate thermoplastic elastomer.

**Version:**

black.

**Note:**

Levelling feet consist of a plate and a threaded spindle. Any plate can be combined with any threaded spindle.

The anti-slip plate absorbs vibrations and prevents the levelling foot slipping.

For matching threaded spindles see K0427.

**Drawing reference:**

Form A without screw-on hole, without anti-slip plate

Form B without screw-on hole, with anti-slip plate

Form C with screw-on hole (closed), without anti-slip plate

Form D with screw-on hole (closed), with anti-slip plate

Form E with screw-on hole (open), without anti-slip plate

Form F with screw-on hole (open), with anti-slip plate

1) From plate Ø 80

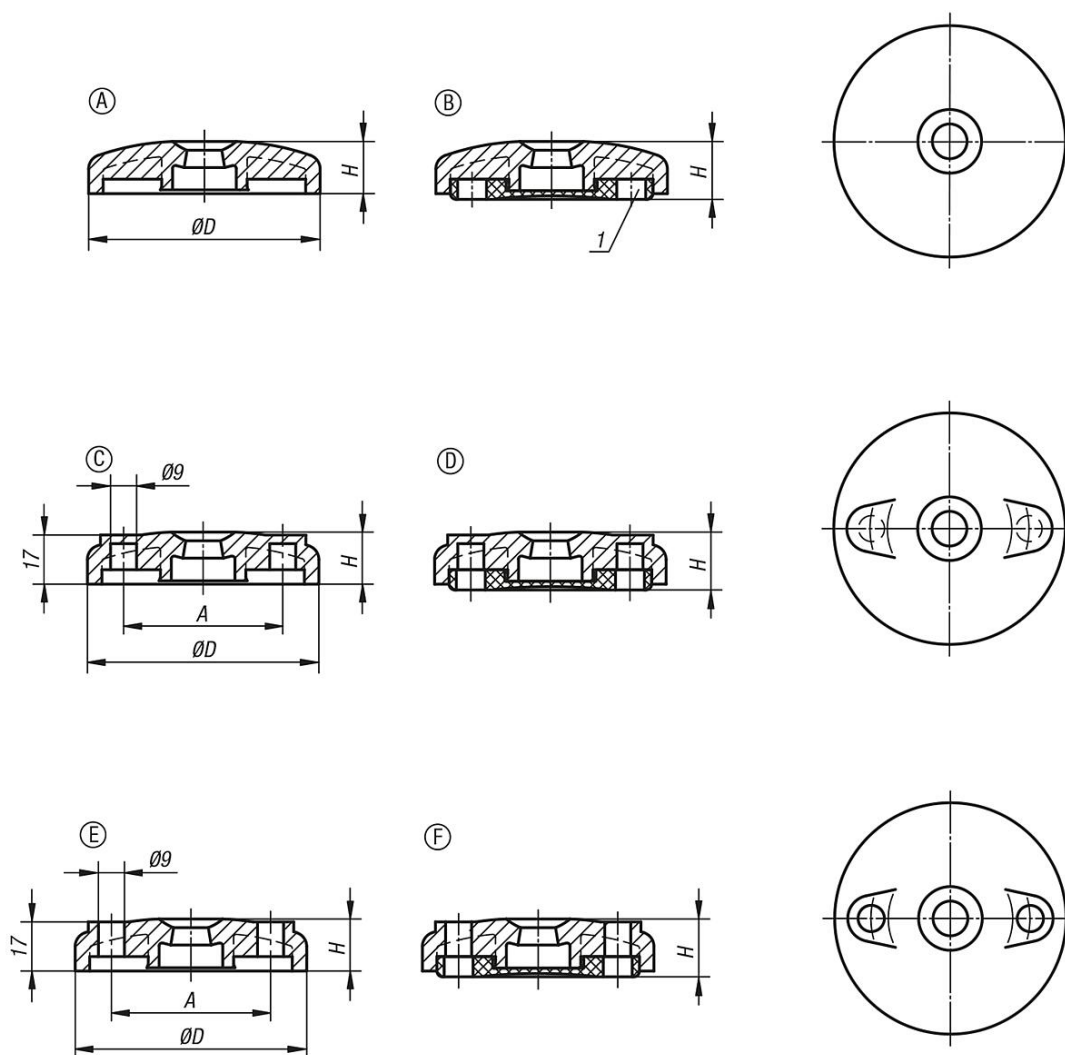
**Drawings**

**Overview of items**
**Levelling feet plates plastic**

Order No.	Form	D	A	H	Load rating max. kN
K0423.1060	A	60	-	18	12
K0423.1080	A	80	-	18	12
K0423.1100	A	100	-	18	12
K0423.2060	B	60	-	20	12
K0423.2080	B	80	-	20	12
K0423.2100	B	100	-	20	12
K0423.3080	C	80	55	18	12
K0423.3100	C	100	74	18	12
K0423.4080	D	80	55	20	12
K0423.4100	D	100	74	20	12
K0423.5080	E	80	55	18	12
K0423.5100	E	100	74	18	12
K0423.6080	F	80	55	20	12
K0423.6100	F	100	74	20	12

