

## Angle plates, grey cast iron, wide with grid holes

### Item description/product images

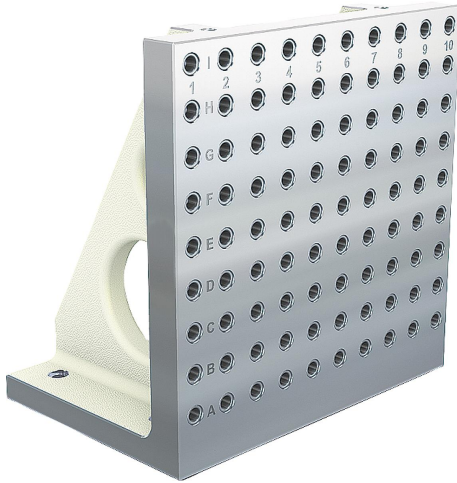

### Description

**Material:**

GJL 300.

**Version:**

Support and mounting surfaces precision machined

**Note:**

Grid spacing  $50 \pm 0.02$  mm.

Angle plates are used for the vertical positioning and mounting of workpieces and fixtures. These angle plates with grid holes provide a quick and economic method of clamping workpieces with standardised clamping elements. The alphanumerically labelled grid holes guarantee a defined assignment of clamping elements by repeat setups.

Ring bolts for hoisting are supplied.

Please order protection plugs to plug unused grid holes separately.

**Drawing reference:**

- 1) grid hole
- 2) hole for DIN 912 cap screw

## Angle plates, grey cast iron, wide with grid holes

### Drawings

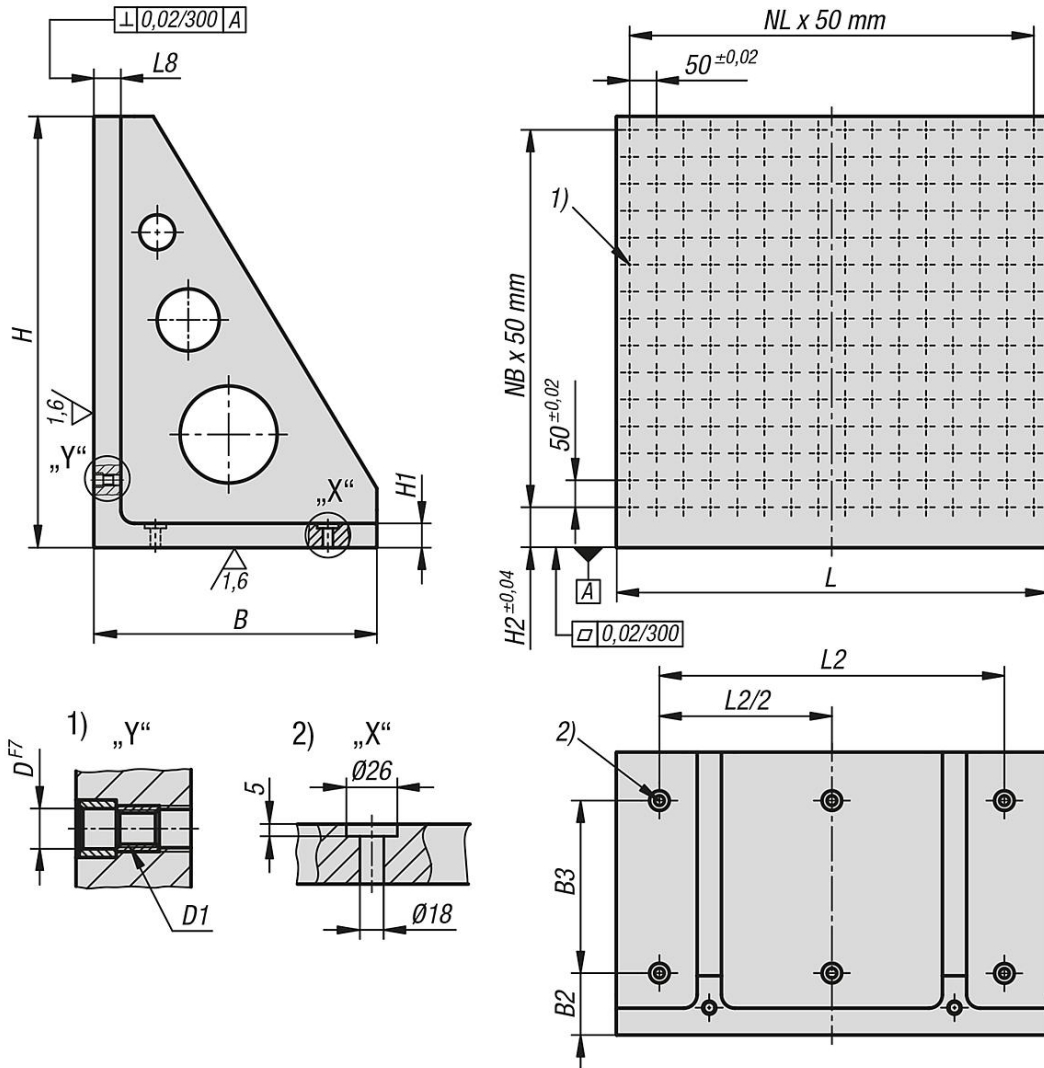

### Overview of items

#### Angle plates, grey cast iron, wide with grid holes

Order No.	L	H	L2	B	B2	B3	H1	H2	L8	D	D1	N1=No. of grid holes	NL=No. lengthwise	NB=No. across
K1531.212302230	300	300	250	220	90	100	30	75	40	12	M12	30	5	4
K1531.212402840	400	400	320	280	90	160	30	75	40	12	M12	56	7	6
K1531.212503450	500	500	400	340	90	200	35	75	50	12	M12	90	9	8
K1531.212634363	630	630	500	435	100	250	40	40	50	12	M12	144	11	11
K1531.212805280	800	800	640	525	115	320	45	75	50	12	M12	240	15	14
K1531.216302230	300	300	250	220	90	100	30	75	40	16	M16	30	5	4
K1531.216402840	400	400	320	280	90	160	30	75	40	16	M16	56	7	6
K1531.216503450	500	500	400	340	90	200	35	75	50	16	M16	90	9	8
K1531.216634363	630	630	500	435	100	250	40	40	50	16	M16	144	11	11
K1531.216805280	800	800	640	525	115	320	45	75	50	16	M16	240	15	14

