

**Attachment step jaws for centric vice, jaw width 80–125 mm, Form B**

Item description/product images



**Description**

**Material:**  
Steel.

**Version:**  
Hardened.

**Note:**  
Attachment step jaws are the base onto which the jaw pads are screwed. They in turn are screwed directly onto the centric vice base. They enable various jaw plates to be exchanged quickly.

Suitable for K1237

**Drawings**

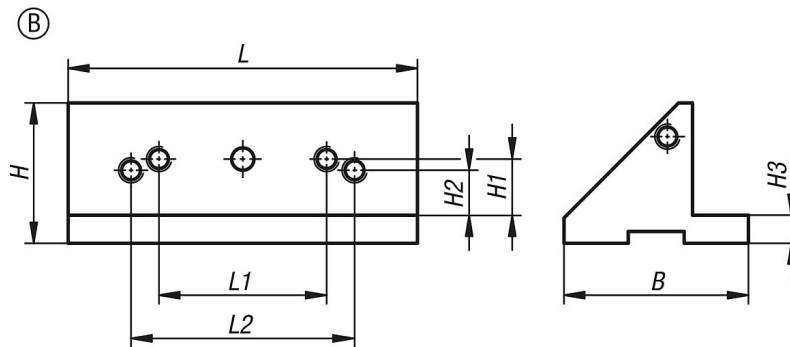

**Overview of items**

Order No.	Form	B	H	H1	H2	H3	L	L1	L2
K1384.12550	B	66	50	20	16	10	125	60	80