

## Inserts for stepped jaws Form B

### Item description/product images



### Description

**Material:**  
Steel.

**Version:**  
Hardened and ground.

**Note:**  
Inserts Form B serrated face for maximum holding force.

### Drawings

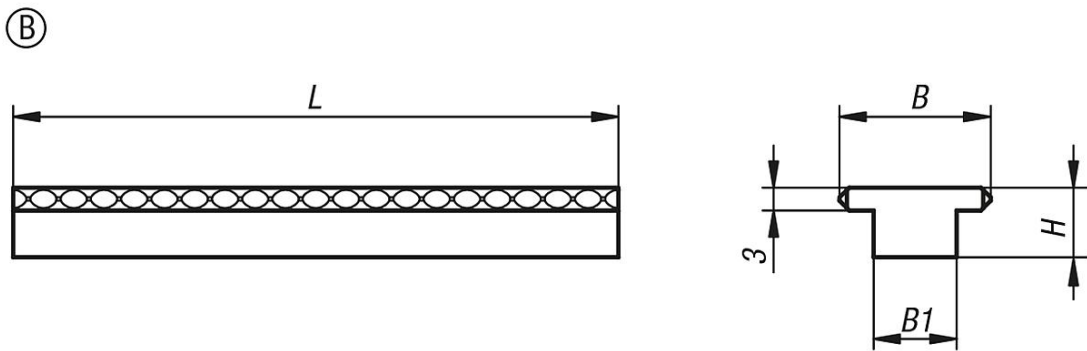

### Overview of items

Order No.	Form	B	B1	H	L
K0591.065217	B	17	11	9,2	65
K0591.080217	B	17	11	9,2	80
K0591.125217	B	17	11	9,2	125