

# Locating pins removeable Form D

## Item description/product images



## Description

**Material:**  
Tool steel.

**Version:**  
Hardened and ground (HRC 55-60).

**Note:**  
Locating pins can be easily removed with an extractor.

## Drawings

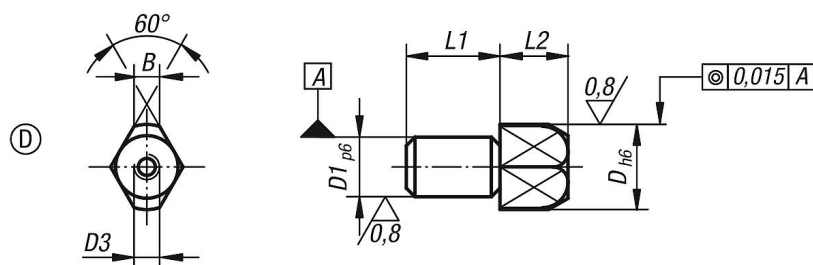

## Overview of items

Order No.	Form	D	D1	D3	L1	L2	L4	B
K0818.102	D	10	7	M3	11	11	3	3
K0818.122	D	12	8	M5	13	12	4	3,5
K0818.162	D	16	12	M5	18	14	4,5	5
K0818.202	D	20	14	M5	22	15	5	6
K0818.222	D	22	16	M5	22	17	5	7
K0818.252	D	25	18	M5	25	17	5	8